

ATLANTIS[®]

RAIL SYSTEMS

VOL. 11



RAILEASY[™]

SUNRAIL[™]

HANDISWAGE[™]

NOVA II

Spectrum
Railing System

Contact Information



Atlantis has implemented a Quality Management System in accordance with ISO 9001.

Telephone
(508) 732-9191

Toll Free
(800) 541-6829

Fax
(508) 732-9798

Web Address
www.atlantisrail.com

Email
info@atlantisrail.com

Mail
Atlantis Rail Systems
70 Armstrong Road
Plymouth, MA 02360



Logos, icons, images, measurements and descriptions are the sole property of Atlantis Rail Systems.

© 2017 Atlantis Rail Systems

Stainless steel products cannot be regarded as completely maintenance free. Low maintenance depends largely on the care given during the first year.

Table of Contents

- NEW PRODUCTS** 2
- RAILEASY™ SYSTEMS** 3
- RAILEASY™ HARDWARE** 6
- SPECTRUM SYSTEM** 16
- NOVA SYSTEMS** 18
- HANDISWAGE™ SYSTEM** 21
- HANDISWAGE™ HARDWARE** 22
- SUNRAIL™ SYSTEMS** 24
- GLASS SYSTEMS** 30
- MICRO STAR™ LED LIGHTING** 32
- RAIL CARE GUIDE** 34
- RAILEASY™ DEALER PROGRAM** 36
- CABLE RAILING STYLES** 37
- QUOTE REQUEST FORM** 38
- MEASURING GUIDE** 39
- INDEX** 40
- COMPANY BACKGROUND**... Inside Back Cover
- COMPANY POLICIES** Inside Back Cover



RAILEASY™ Pg. 3

- RailEasy™ Systems** 3-5
 - Overview 3
 - RailEasy™ Nautilus 4
 - RailEasy™ Cable Railing 5
- RailEasy™ Hardware** 6-15
 - RailEasy™ Tensioner 6
 - RailEasy™ Swivel End 7
 - RailEasy™ Lag Stud 8
 - RailEasy™ Stud Assembly 8
 - RailEasy™ Cable Sleeve 9
 - RailEasy™ Flush Fitting 9
 - RailEasy™ Product 10-15, 31



SPECTRUM Pg. 16

- Spectrum System** 16-17
 - Overview 16
 - Color Selection 16
 - Cable Infill Option 16
 - Spectrum Post Kits 17
 - Top Mounting Plate Assembly... 17
 - Corner Mending Plate Set 17
 - Accessories 17



NOVA SYSTEMS Pg. 18

- NOVA Systems** 18-20
 - Overview 18
 - NOVA II 19
 - NOVA 20



HANDISWAGE™ Pg. 21

- HandiSwage™ System** 21
 - Overview 21
 - HandiSwage™ Hardware 22-23



SUNRAIL™ Pg. 24

- SunRail™ Systems** 24-27
 - Overview 24
 - Residential 25
 - Commercial 26
 - Custom 27
 - ADA Compliant 27



LATITUDE Pg. 28

- SunRail™ Latitude** 28-29
 - Overview 28
 - Cable Railing Infill 28
 - Latitude Post Kits 29
 - Top Plate Mounting Assembly... 29
 - Stair Fitting 29
 - Fascia Mount 29



GLASS SYSTEMS (Pg. 30)
The glass systems feature multiple glass clamp styles to fit a variety of posts and rails.



LED LIGHTING (Pg. 32)
The Micro Star™ series is a functional and creative lighting alternative for many indoor or outdoor railing applications.

What's New at Atlantis Rail

NEW PRODUCTS

NOVA II

The NOVA II System features powder-coated aluminum posts, hand-rails and foot rails and horizontal cable infill. The cable infill utilizes HandiSwage™ fittings with 1/8" cable. This system is offered in black, white and bronze colors at a 36" or 42" height. There are 6 post kits which include drilled, undrilled and corner kits. The top and bottom rails are packaged together in 6' lengths. Each post and rail kit includes everything needed for installation, excluding post mounting hardware. Post mounting hardware, cable and cable mounting hardware are sold separately.

PAGE 19



PAGE 33

TRI STAR SURFACE MOUNT

The Tri Star Surface Mount is a self-contained unit with 3 LEDs. This LED light is 12 volt and offered in a white color. It is fastened using three #8 screws. The Tri Star Surface Mount is perfect for mounting to posts in railing applications to illuminate the decking. Use with the Micro Star™ Transformers.



PAGE 33 **microstar™**

5 AMP MICRO STAR™ TRANSFORMER

This Micro Star™ Transformer can be used to power more Micro Star™ lighting than the 1 amp transformer. The heavy duty, water resistant construction provides years of reliable service. This transformer is DC and UL approved. It features a 6 ft. power cord and a 10 ft. connector lead.



PAGE 23

NEW HANDISWAGE™ COVER NUT SETS

The style of the decorative cover nut has changed to allow for a flush fit against the post. In the past, the old style of cover nuts wouldn't sit flush on the post if the threaded stud of the HandiSwage™ Studs or RailEasy™ Stud Assemblies weren't cut flush. With this new style, the threads don't have to be cut flush to the locking nut for the cover nut to fit.

ATLANTIS RAIL PHOTO CONTEST

SEND US PHOTOS FROM YOUR LATEST ATLANTIS RAIL PROJECT FOR A CHANCE TO WIN!

1st Place: \$500 | 2nd Place: \$250 | 3rd Place: \$100

ALL ENTRIES RECEIVE A FREE RAIL CARE KIT!

HOW TO ENTER: Email your contact information (Name/Company Name, Address, Phone Number, Email Address) along with your photo entry to: carey@atlantisrail.com.

Atlantis Rail reserves the right to pick the winner at our discretion. Photo contest is available to homeowners and contractors only. Atlantis Rail Authorized Dealers are not eligible for prizes. Under no circumstance will Atlantis Rail sell or distribute your contact information. Digitally altered photos will be disqualified. Project must be code compliant. Submitted photos must depict Atlantis Rail products only. Two contests will be run during each calendar year. Entries are valid only for the period in which they are submitted. Submission of photos grants Atlantis Rail Systems the right to use submitted photos in any way it deems fit.





RAILEASY™

A Revolutionary Approach to the Conventional

Atlantis Rails' RailEasy™ Systems offer a revolutionary approach to conventional railing systems. This innovative collection of low maintenance railings offers unobstructed views and is capable of fitting any indoor or outdoor design. Enjoy the streamlined look of our unique RailEasy™ models with infill options of cable railing and glass panels. We invite you to discover the beauty and durability of stainless steel railing systems.



Visit the **Atlantis Rail website** for complete installation instructions, as well as, a comprehensive gallery of RailEasy™ application photos.

RailEasy™ Systems..... 3-5
 RailEasy™ Nautilus.....4
 RailEasy™ Cable Railing.....5

RailEasy™ Hardware.....6-15



RailEasy™ Nautilus (Optional Bottom Rail)

COST: \$ \$ \$ \$

PRODUCT INFORMATION

Straight Sections

Atlantis Rail offers standard rail heights of 36" or 42" for straight sections.

Stair Sections

Rail height for stair sections are available in 36" only.

Note: Railing heights are offered in these dimensions due to nationwide building codes. However, Atlantis Rail Systems can supply custom heights/lengths upon request.

Between Posts Length

Atlantis Rail Systems recommends staying within 4' section lengths to maintain structural integrity.

Cable Spacing

Atlantis Rail Systems recommends spacing cables 3" on-center to comply with nationwide building codes.

Optional Components

Vinyl Post Components - White vinyl sleeves, fitting over a 4"x 4" post, are available in lengths of 48". Cut post sleeves to appropriate application height. Colonial style white vinyl post cap and base are also available as railing add-ons (see pgs. 14-15).

Micro Star™ Lighting - Micro Star™ LED Lights can be integrated into the top rail for subtle illumination. Also, the Micro Star™ LED Post Cap fits over standard 4"x 4" vinyl sleeves and provides sufficient lighting for stairs and walkways (see pg. 33).

FEATURES & BENEFITS

The RailEasy™ Nautilus System combines the modern look of stainless steel cable and tensioners with the low maintenance quality of highly polished or brushed tubing and optional vinyl post components.

Marine Grade Stainless Steel

The RailEasy™ Nautilus is made from the extremely corrosion resistant type 316L stainless steel to add years of long term value and enjoyment.

Ease of Installation

Cable assemblies are connected in the field utilizing patented RailEasy™ Tensioners, which are installed using simple hand tools.

Streamlined

Horizontal cable infill provides unobstructed views, while allowing ventilation.

Versatility

The RailEasy™ Nautilus System is offered in a highly polished or brushed finish to blend with every environment.

SPECIFICATIONS

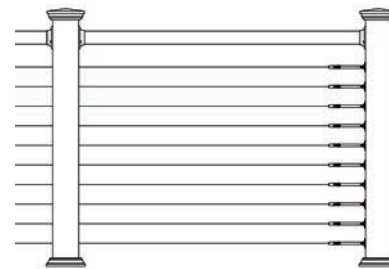

36" RAILEASY™ NAUTILUS

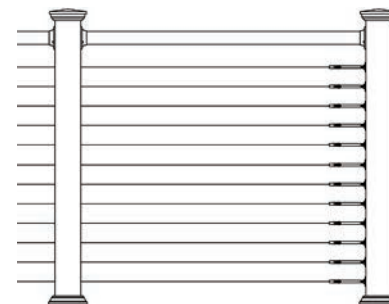

42" RAILEASY™ NAUTILUS

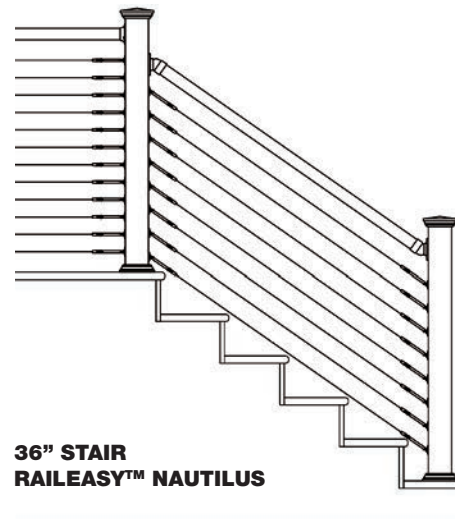

36" STAIR RAILEASY™ NAUTILUS



RailEasy™ Cable Railing (Cable & Tensioners ONLY) COST: \$\$\$\$

PRODUCT INFORMATION

Straight Sections

Atlantis Rail offers standard railing heights of 36" or 42" for straight sections.

Stair Sections

Rail height for stair sections are available in 36" only.

Note: Railing heights are offered in these dimensions due to nationwide building codes. However, Atlantis Rail Systems can supply custom heights/lengths upon request.

Between Posts Length

Atlantis Rail Systems recommends staying within 4' section lengths to maintain structural integrity. If section lengths exceed 4', Atlantis Rail offers a Cable Stabilizer Kit to minimize cable deflection (see pg. 15).

Cable Spacing

Atlantis Rail Systems recommends spacing cables 3" on-center to comply with nationwide building codes.

Optional Components

Vinyl Post Components - White vinyl sleeves, fitting over a 4"x 4" post, are available in lengths of 48". Cut post sleeves to appropriate application height. Colonial style white vinyl post cap and base are also available as railing add-ons (see pgs. 14-15).

Micro Star™ Lighting - The Micro Star™ LED Post Cap fits over standard 4"x 4" vinyl sleeves and provides sufficient lighting for stairs and walkways (see pg. 33).

FEATURES & BENEFITS

The RailEasy™ Cable Railing System combines the natural beauty of wood with the streamlined look of patented RailEasy™ Tensioners and cable.

Marine Grade Stainless Steel

RailEasy™ Tensioners and cable are made from the extremely corrosion resistant type 316L stainless steel and factory electro-polished to add years of long term value and enjoyment.

Ease of Installation

Cable assemblies are connected in the field utilizing patented RailEasy™ Tensioners, which are installed using simple hand tools.

Streamlined

Horizontal cable infill provides unobstructed views, while allowing ventilation.

Cost Efficient

The RailEasy™ Cable Railing is an affordable approach to having a contemporary look.

SPECIFICATIONS

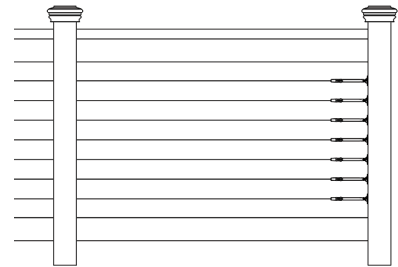

36" RAILEASY™ CABLE RAILING
(Cable & Tensioners)

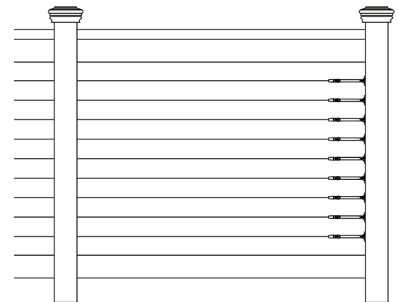

42" RAILEASY™ CABLE RAILING
(Cable & Tensioners)

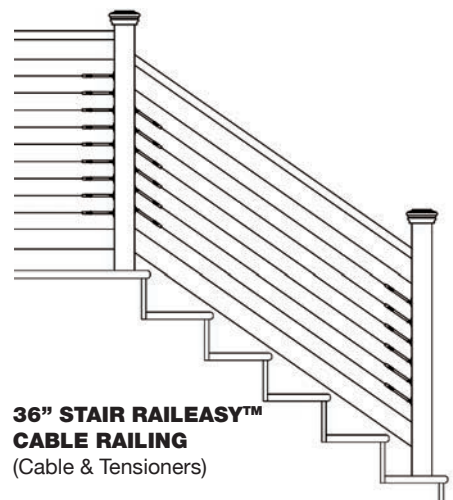

36" STAIR RAILEASY™ CABLE RAILING
(Cable & Tensioners)

RAILEASY™

Featured Hardware



RAILEASY™ TENSIONER

The RailEasy™ Tensioner features mechanical swaging capabilities that allow installers to cut cable on site, removing the hassle of pre-measuring and the cost of miscalculating dimensions. Each tensioner is made up of durable, corrosion resistant marine grade stainless steel.



Patented Base Detail

Each base is slotted to achieve angles up to 45 degrees on stair and angled rails.

RailEasy™ Tensioner Components

1. Patented Base
2. Tensioner Body
3. Lock Nut
4. Threaded Stud
5. Spacer
6. Wedge
7. Receiver Cone

Step 1



Fully seat wire rope.

Step 2



Tighten cone onto receiver.

Step 3



Rotate body to tension.



RailEasy™ Tensioners have two standard bases; one designed for a flat surface (above) and one to fit our 2" stainless steel posts (right). The slotted base design on both allows for angles up to 45 degrees, which is ideal for stair applications.



FEATURES & BENEFITS

Marine Grade Stainless Steel

Tensioners are made of type 316L stainless steel and factory electro-polished for durability and corrosion resistance.

Mechanical Swage Fitting

Cable is attached quickly and easily with simple hand tools.

Multiple Designs

Patented RailEasy™ Tensioners are designed to handle any indoor or outdoor application.

Slotted Base

Each tensioner is capable of accommodating angles to 45 degrees up, down, or side to side, making it perfect for stair applications.



Curved base also available.

RAILEASY™

Patented Simplicity

The RailEasy™ cable system is an attractive, affordable and low maintenance railing infill option for any indoor or outdoor application. These RailEasy™ fittings are made from marine grade stainless steel and fit a 5/32" diameter stainless steel cable. In addition to the standard RailEasy™ Tensioner, Atlantis Rail has developed additional fittings as alternative options.

Proper Tensioning Sequence

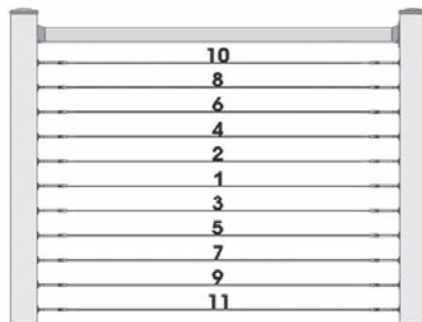

Follow the recommended tensioning sequence above to ensure proper installation and to achieve optimal results.

RAILEASY™ SWIVEL END

Use the swivel end in conjunction with a tensioner on short sections for a cost effective way of having a unique look while still maintaining the view.



Tensioning Illustration: **Swivel End Flat**

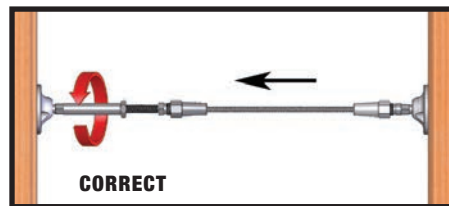

For cable sections using the RailEasy™ Swivel End, there must be a RailEasy™ Tensioner on one end for tensioning capabilities. Cable spans may not exceed 25 feet when using a swivel end.

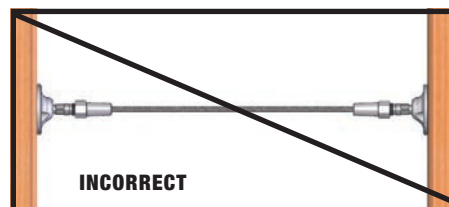

Do not use two RailEasy™ Swivel Ends on any given cable run. They simply hold the cable and have no tensioning capabilities.

The RailEasy™ Swivel End is designed for use in short runs and straight sections less than 25 feet. It must always be used with a RailEasy™ Tensioner at the opposite end of the cable run for tensioning capabilities. The compression fitting holds the cable using simple hand tools and the slotted base allows for angles up to 45 degrees, making it ideal for stair applications. The swivel ends are surface mounted with three #8, 1-1/2" stainless steel screws. They are a cost effective way of having unique railings while still maintaining the view.

FEATURES & BENEFITS

Marine Grade Stainless Steel

Swivel ends are made from type 316L stainless steel and factory electro-polished for durability and corrosion resistance.

Mechanical Swage Fitting

Cable is attached quickly and easily with simple hand tools.

Slotted Base

Each swivel end is capable of accommodating angles to 45 degrees, making it perfect for angles and stair applications.

Alternative Option

The RailEasy™ Swivel End is an alternative option to having a tensioner on either end of a cable run. Also, it offers an even cleaner looking cable railing system.



RAILEASY™ LAG STUD



Use the lag stud in conjunction with a tensioner on short sections for an alternative and cost effective option.

The RailEasy™ Lag Stud is designed for use in short runs and must always be used with a RailEasy™ Tensioner at the opposite end of the cable run for tensioning capabilities. These fittings are made from marine grade stainless steel and are available with a right and left hand thread. The compression fitting holds the cable using simple hand tools. Holes must be pre-drilled before installing RailEasy™ Lag Studs.

Tensioning Illustration: **Tensioner / Lag Stud**

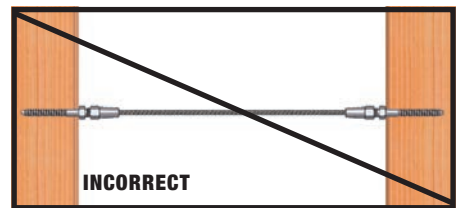
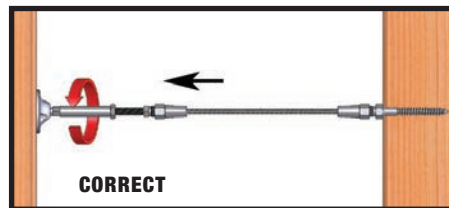

When utilizing a RailEasy™ Lag Stud, always use a RailEasy™ Tensioner at the other end of the cable run for maximum tensioning capabilities.

Do not use two RailEasy™ Lag Studs on the same cable run. They have very limited tensioning capabilities when used as a pair.

RAILEASY™ STUD ASSEMBLY



Use the stud assembly to achieve a “through-post” look.

The RailEasy™ Stud Assembly is used for cable railing applications where a “through-post” look is desired. It is made from grade 316L stainless steel and has a compression fitting for quick and easy installation. The assembly is used on straight and angled runs (Stair Spacers are available for angles upon request) by drilling through the post and fixing it to the back side. Tighten the hex nut to tension and cut off the excess thread to fit the acorn nut. Stainless steel and HandiSwage™ Cover Nut Sets are available (pg. 23).



Step 1 Tighten nut to tension



Step 2 Cut thread leaving 1/4”



Step 3 Install acorn nut



RAILEASY™ CABLE SLEEVE

Use the cable sleeve to accommodate angles up to 90 degrees and stairways coming off a straight run.

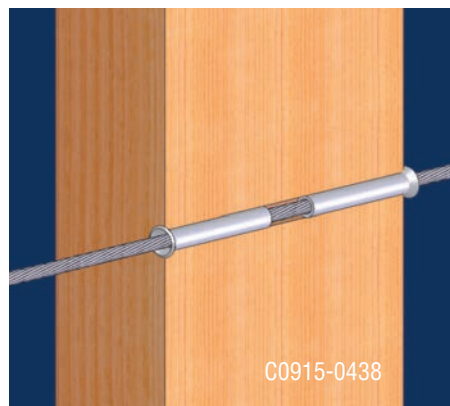

The RailEasy™ Cable Sleeve is designed to protect wood posts from chafing and incidental damage from the cables rubbing around the outside of your mid post cable holes. It can also be used to accommodate angles up to 90 degrees and stairways coming off a straight run (see cable sleeve illustration). The cable sleeves are made from marine grade, type 316L, stainless steel and factory electro-polished for maximum durability and corrosion resistance. To install, drill a 1/4" hole and tap in the cable sleeve for a snug fit.

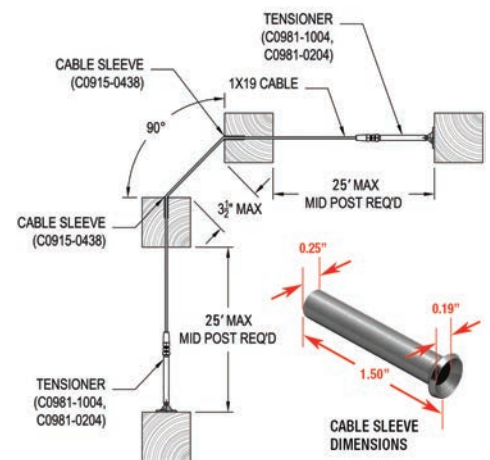

Cable Sleeve Illustration: **Usage Guidelines**

RAILEASY™ FLUSH FITTING

Use the flush fitting for an ultra-clean "through post" installation. Fittings are concealed within the post and finished with a deluxe cap.

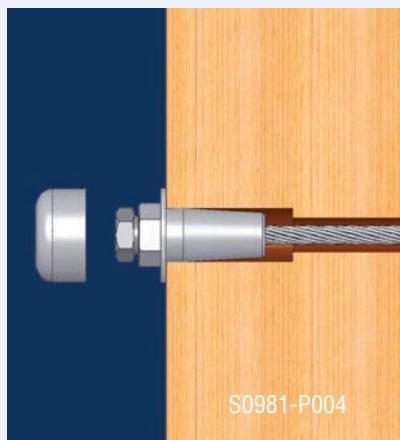

The RailEasy™ Flush Fitting is perfect for architectural cable railing applications where "through post" hardware is desired. These fittings feature a mechanical swage design, which allows attachment to cable with the use of simple hand tools. The RailEasy™ Flush Fitting is a fixed termination point and must be used in conjunction with a RailEasy™ tensioning device at the opposite end of each cable run. The supplied stainless steel deluxe cap provides a clean, finished look.



RAILEASY™ TENSIONER - FLAT

316L STAINLESS STEEL

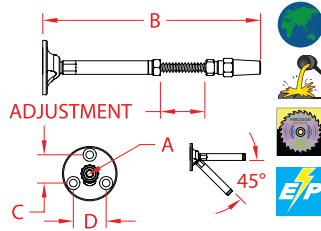

ITEM	A	B	C	D	ADJ	FAST	QTY	WT
	(cable)							(lb)
2 PACK C0981-0204	5/32"	5.40"	0.78"	0.90"	1.35"	#8	2	0.42
10 PACK C0981-1004	5/32"	5.40"	0.78"	0.90"	1.35"	#8	10	1.96
SINGLE - 3/16" ONLY S0981-0005	3/16"	5.90"	0.78"	0.90"	1.35"	#8	1	0.20

NOTE:
Patented tensioner is used for cable railing applications. Slotted base allows for angles up to 45 degrees and is used at either end of cable runs. Compression fitting allows for tensioning with simple hand tools. Flat base can be fixed on any level surface at any orientation and stays fixed while allowing the body to rotate during tensioning of cable.



RAILEASY™ TENSIONER - ROUND

316L STAINLESS STEEL

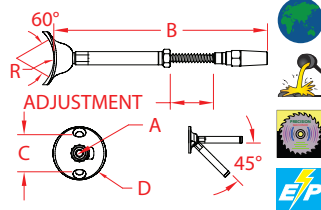

ITEM	A	B	C	D	ADJ	FAST	WT	
	(cable)							(lb)
S0982-0004	5/32"	5.50"	1.00"	1.50"	1.35"	3/16" Rivet	0.17	

NOTE:
Patented tensioner is used for cable railing applications. Slotted base allows for angles up to 45 degrees and is used at either end of cable runs. Compression fitting allows for tensioning with simple hand tools. Round shaped base is designed for use with 2" outside diameter stainless tubing and stays fixed while allowing the body to rotate during tensioning of cable. Requires rivets to attach to tubing (supplied with complete SunRail™ systems).



RAILEASY™ SWIVEL END-FLAT

316L STAINLESS STEEL

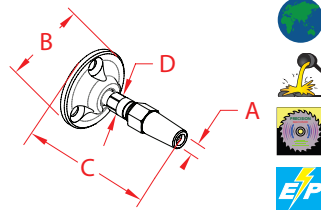

ITEM	A	B	C	D	FAST	QTY	WT	
	(cable)							(lb)
2 PACK C0981-S024	5/32"	1.50"	2.26"	0.31"	#8	2	0.31	
10 PACK C0981-S104	5/32"	1.50"	2.26"	0.31"	#8	10	1.43	

NOTE:
Patented swivel end is used for cable railing applications. Swivel end is used in conjunction with RailEasy™ Tensioner in order to tension cable. Slotted base allows for angles up to 45 degrees and is surface mounted with three #8, 1-1/2" stainless steel screws.



RAILEASY™ SWIVEL END-ROUND

316L STAINLESS STEEL

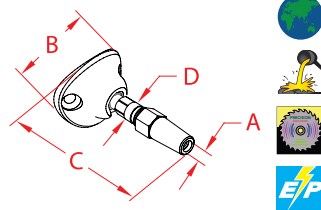

ITEM	A	B	C	D	FAST	WT	
	(cable)						(lb)
S0982-S004	5/32"	1.50"	2.30"	0.31"	3/16" Rivet	0.13	

NOTE:
Patented swivel end is used for cable railing applications. Swivel end is used in conjunction with RailEasy™ Tensioner (S0982-0004) in order to tension cable. Slotted base allows for angles up to 45 degrees and round shape is designed for use with 2" outside diameter stainless tubing. Requires rivets to attach to tubing (supplied with complete SunRail™ systems).



RAILEASY™ FLUSH FITTING

316L STAINLESS STEEL

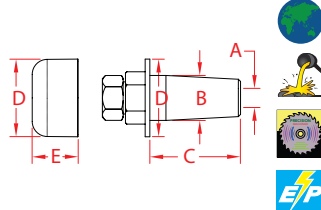

ITEM	A	B	C	D	E	WT	
	(cable)						(lb)
S0981-P004	5/32"	0.43"	0.84"	0.75"	0.45"	0.05	

NOTE:
The RailEasy™ Flush Fitting is perfect for architectural cable railing applications where "through post" hardware is desired for minimal obstruction. Fitting uses mechanical swage design to attach to cable. Affix the supplied stainless steel deluxe cap to the end for a finished look.



RAILEASY™ STUD ASSEMBLY

316L STAINLESS STEEL

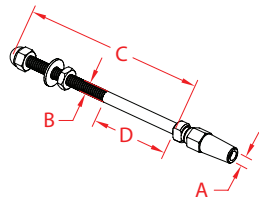

ITEM	A	B	C	D	QTY	WT
	(cable)					(lb)
2 PACK C0980-0004-2	5/32"	1/4"-28	4.50"	1.50"	2	0.25
SINGLE - 3/16" ONLY S0980-0005	3/16"	1/4"-28	4.50"	1.50"	1	0.16

NOTE:
Patented tensioner is used for cable railing applications. Assembly is used on straight and angled (Stair Spacers are available for angles, see pg. 22) runs by drilling through the post and fixing it to the back side. Tighten lock nut to tension and cut off excess thread to fit acorn nut.



RAILEASY™ LAG STUD

316L STAINLESS STEEL

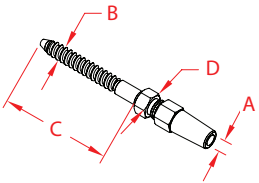

ITEM	A	B	C	D	THREAD	QTY	WT
	(cable)						(lb)
2 PACK C0980-R004-2	5/32"	0.28"	2.25"	0.44"	Right Hand	2	0.17

NOTE:
Patented lag stud is used for cable railing applications. Stud is used on straight run with a RailEasy™ Tensioner to ensure cable tautness. Installation involves pre-drilling of posts and requires only simple hand tools.



RAILEASY™ STUD

316L STAINLESS STEEL

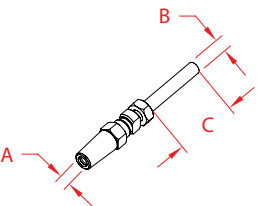

ITEM	A	B	C	WT
	(cable)			(lb)
S0980-0003	5/32"	1/4"-28	1.75"	0.07

NOTE:
Patented tensioner stud is used on one side of a cable railing application. A RailEasy™ Tensioner is needed at the other side for tensioning capabilities. Stud is UNF threaded.



RAILEASY™ WEDGES - 10 PACK

316 STAINLESS STEEL

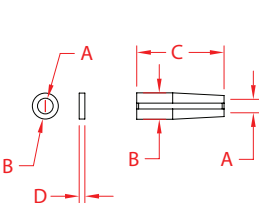

ITEM	A	B	C	D	QUANTITY	WT
						(lb)
WEDGES - 10 PACK S0980-0001	5/32"	0.28"	0.85"	0.06"	10	0.02

NOTE:
Includes 10 spacers and 10 wedges. Components are located in the cone of each tensioner. Weight listed above is for complete 10 pack.



RAILEASY™ CONES - 4 PACK

316L STAINLESS STEEL

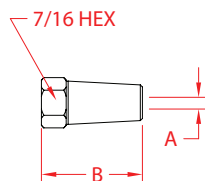

ITEM	A	B	QUANTITY	WT
				(lb)
CONES - 4 PACK S0980-0002	0.22"	1.11"	4	0.08

NOTE:
Tensioner cone is where the spacer and wedge are housed. 4 Pack does not include spacers and wedges. Weight listed above is for complete 4 pack.



RAILEASY™ CABLE SLEEVES

316L STAINLESS STEEL

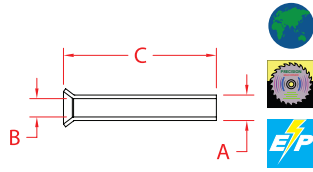

ITEM	A	B	C	QTY.	WT
					(lb)
10 PACK C0915-0438	0.25"	0.19"	1.50"	10	0.09

NOTE:
The RailEasy™ Cable Sleeve is designed to protect your wood posts from chafing and incidental damage from cable rubbing around the outside of your mid post cable holes. It can also be used to accommodate angles up to 90 degrees and stairways coming off a straight run.

RAILEASY™ CABLE

316L STAINLESS STEEL

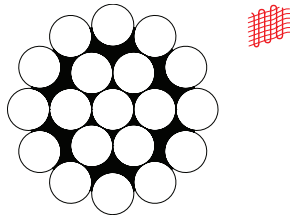
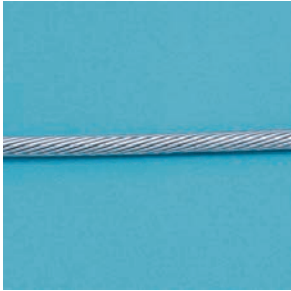

ITEM	SIZE	SPOOL	WT
			(lb)
C0978-4025	5/32"	25'	1.44
C0978-4100	5/32"	100'	6.84
C0978-4500	5/32"	500'	32.62
S0701-0005	3/16"	CUTS	8.00*

NOTE:
1X19 wire is left hand lay. Weight for part numbers C0978-4100 and C0978-4500, includes reel. Use E0111-WR06 Cable Cutter for 3/16" cable.
* = Weight per 100' in pounds, without reel.

RAILEASY™ CABLE CUTTER

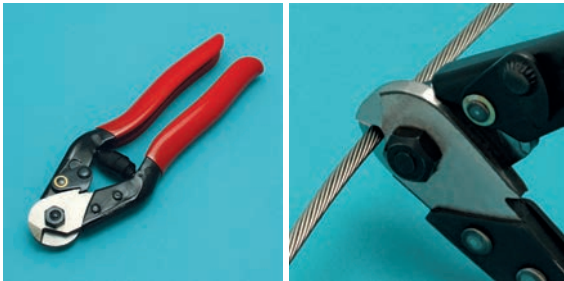

ITEM	WT
(lb)	
HEAVY DUTY C0989-00HD	0.75

NOTE:
Hardened heat treated blades cut 5/32" cable for railing systems cleanly and quickly for an easy installation.

CABLE CUTTER



ITEM	SIZE	CUTS TO	WT
			(lb)
(length)			
E0111-WR06	14"	3/16"	2.10
E0111-WR10	24"	1/4"	5.25

NOTE:
Blades cut cable for railing systems cleanly and quickly for an easy installation. Longer handles provide more leverage for cutting cable.

RAILEASY™ INSTALLATION TOOLS



ITEM	WT
(lb)	
C0988-0000	0.37

NOTE:
Kit includes: 5/16", 3/8" & 7/16" open wrenches, 7/32" & 1/8" drill bits and #2 stainless steel Phillips head & square head driver bits. Installation tools are used on railing systems where RailEasy™ Tensioners are utilized.

C0988-4000-2 - "CABLE LACING NEEDLE (2 PACK)"
Use with 1/8" and 5/32" cable. Lacing needle helps guide cable through post holes without snagging to make for a quick and easy cable railing installation.

RAILEASY™ DRILLING TEMPLATE



ALUMINUM

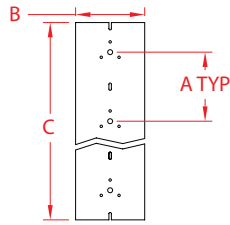

ITEM	A	B	C	WT
				(lb)
C0988-1000	3.00"	3.50"	24.00"	0.19

NOTE:
Drilling template allows for easy installation of RailEasy™ cable railing systems. Cable runs are spaced 3" on-center for either a 36" or 42" height railing system. Hole pattern designed specifically for mounting tensioners on end/ corner posts and for drilling "through-holes" in mid posts.



RAIL WOOD SCREW



316L STAINLESS STEEL

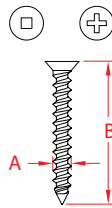

ITEM	SIZE	A	B	TYPE	QTY.	WT
						(lb)
S0917-0538-10	#8	0.16"	1.50"	Square	10	0.06
S0914-0538-10	#8	0.16"	1.50"	Phillips	10	0.06
S0917-0638-8	#10	0.19"	1.50"	Square	8	0.07
S0914-0638-8	#10	0.19"	1.50"	Phillips	8	0.07
BULK - 1 LB						
S0914-0538-1LB	#8	0.16"	1.50"	Phillips	1 lb (160 pcs)	1.00
S0914-0638-1LB	#10	0.19"	1.50"	Phillips	1 lb (120 pcs)	1.00

NOTE:
Stainless steel screw with coarse thread is used for fastening into wood. The #8 screw is used for mounting the flat base RailEasy™ Tensioners and Swivel Ends. The #10 screw is used for mounting RailEasy™ Straight and Adjustable Sidemounts.

STAINLESS DRIVER BITS



ITEM	SIZE	LENGTH	QTY	WT
				(lb)
PHILLIPS - 410 STAINLESS STEEL				
E0101-PH02-C-2	#2	1" (25mm)	2	0.04
E0101-PHL2-C-2	#2	2" (50mm)	2	0.06
E0101-PH03-C-2	#3	1" (25mm)	2	0.04
E0101-PHL3-C-2	#3	2" (50mm)	2	0.07
SQUARE - 410 STAINLESS STEEL				
E0101-SL02-C-2	#2	2" (50mm)	2	0.06

NOTE: These driver bits are available in #2 or #3 sizes and 1" or 2" lengths. They are offered in a quantity of 2, however, bulk orders are available upon request. Using stainless driver bits prevents contamination of stainless screw heads. Using typical steel bits can cause stainless fasteners to stain if stripping occurs during installation.

FASTENER LUBRICANT



ITEM	SIZE	WT
		(lb)
E0102-0000	2.5 oz	0.19

NOTE:
This Fastener Lubricant contains beeswax. Apply a small amount of lubricant to any threaded surface to ease threading. It is very effective on wood screws to eliminate the stripping of screw heads and to speed up the installation process.

RAILEASY™ STRAIGHT SIDEMOUNT



316L STAINLESS STEEL

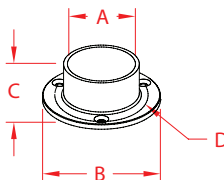

ITEM	SIZE	A	B	C	D	FAST.	WT
							(lb)
POLISHED - 2 PACK							
C0975-0002	2"	2.02"	3.50"	1.23"	2.88"	#10	1.01
BRUSHED							
S0975-0000-B	2"	2.02"	3.50"	1.23"	2.88"	#10	0.40

NOTE:
The outside dimension of the sidemount matches the width of a standard vinyl post, and is also suitable for other types of standard 4"x4" posts. Tube is placed inside mount, therefore the ends can be cut on-site; no precision cutting is required. Set screws are included to lock tubing and to prevent turning. Fasteners are included in the 2 pack.

RAILEASY™ ADJUSTABLE SIDEMOUNT

316L STAINLESS STEEL

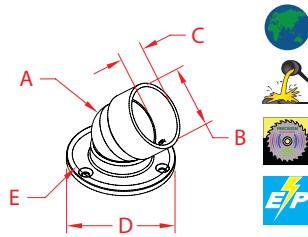

ITEM	SIZE	A	B	C	D	E	FAST.	WT
(lb)								
POLISHED - 2 PACK								
C0976-0002	2"	2.00"	2.01"	1.00"	3.50"	2.88"	#10	3.13
BRUSHED								
S0976-0000-B	2"	2.00"	2.01"	1.00"	3.50"	2.88"	#10	1.46
NOTE:								
Patented design can accept any angle up to 45 degrees in one of four directions, while keeping the perpendicular directions immovable.								
Tube is placed inside mount, therefore the ends can be cut on-site; no precision cutting is required. Set screws are included to lock tubing and to prevent turning. Fasteners are included in the 2 pack.								

RAILEASY™ TUBING

316L STAINLESS STEEL

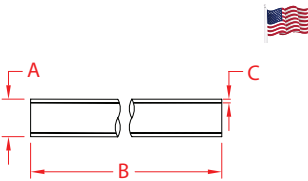
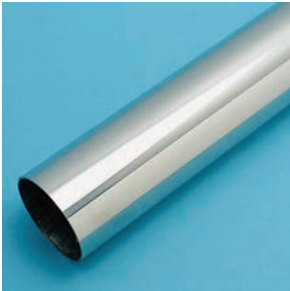

ITEM	SIZE	A	B	C	WT
(lb)					
POLISHED - BY THE FOOT					
S0900-0038	1-1/2"	1.50"	12.00"	0.062"	0.85
S0900-0050	2"	2.00"	12.00"	0.062"	1.34
BRUSHED - BY THE FOOT					
S0900-B038	1-1/2"	1.50"	12.00"	0.062"	0.85
S0900-B050	2"	2.00"	12.00"	0.062"	1.34
POLISHED - STANDARD LENGTHS					
C0973-0900	2"x 36"	2.00"	36.00"	0.062"	4.02
C0973-1200	2"x 48"	2.00"	48.00"	0.062"	5.36
C0973-1500	2"x 60"	2.00"	60.00"	0.062"	6.70
BRUSHED - STANDARD LENGTHS					
S0973-0900-B	2"x 36"	2.00"	36.00"	0.062"	4.02
S0973-1200-B	2"x 48"	2.00"	48.00"	0.062"	5.36
S0973-1500-B	2"x 60"	2.00"	60.00"	0.062"	6.70
NOTE:					
Stainless steel tubing is type 316L. Standard lengths of 3 feet, 4 feet and 5 feet are used as top and bottom rails for the RailEasy™ and SunRail™ systems. Tubing is available in a highly polished or brushed finish.					

RAILEASY™ COLONIAL POST CAP

VINYL

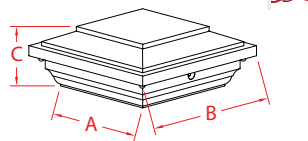
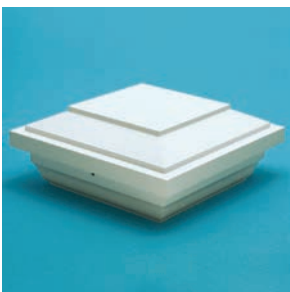

ITEM	A	B	C	WT
(lb)				
S0984-0000	4.03"	5.75"	2.13"	0.40
NOTE:				
Standard cap dimensioned to fit over RailEasy™ Sleeve. Post cap is constructed of durable white vinyl.				

RAILEASY™ COLONIAL POST BASE

VINYL

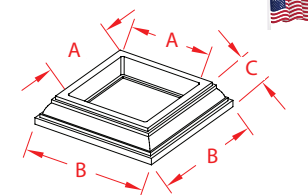
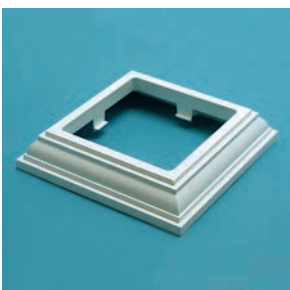

ITEM	A	B	C	WT
(lb)				
S0984-0001	4.03"	6.00"	1.42"	0.20
NOTE:				
Standard post skirt dimensioned to fit over RailEasy™ Sleeve. Post skirt is constructed of durable white vinyl. Always install the post skirt over sleeve at the base first before installing the railing sections.				

RAILEASY™ SLEEVE

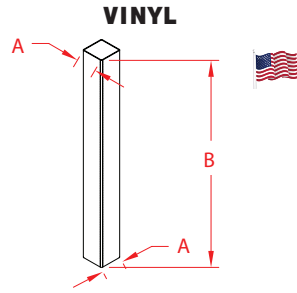
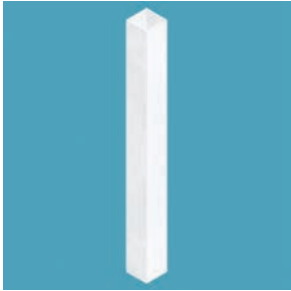

ITEM	SIZE	A	B	WT
				(lb)
S0983-1000	4"x 4"	4.00"	48.00"	5.00

NOTE:
Accent RailEasy™ Systems with vinyl post sleeves, designed to fit over 4"x4" wood posts.

CABLE STABILIZER KIT



316L STAINLESS STEEL

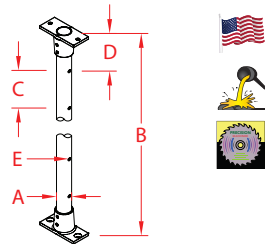

ITEM	A	B	C	D	E	WT
						(lb)
S0950-0060	1"	42.00"	3.00"	3.00"	0.22"	2.90

NOTE:
The Cable Stabilizer Kit is designed specifically for use where post to post measurement spans over 4'. It enables you to adapt longer spans to code compliance by stabilizing the deflection of cable between posts. Each kit comes with a 42" stanchion pre-drilled to work with our standard 3" spacing. In most cases, stanchions must be field cut at both ends for an accurate fit. The Cable Stabilizer Kit cannot be used to replace the use of substantial mid posts and should never be used in spans over 7'. Kit includes fasteners.
SEE ADDITIONAL INFORMATION BELOW.

CABLE STABILIZER STAIR KIT



316L STAINLESS STEEL

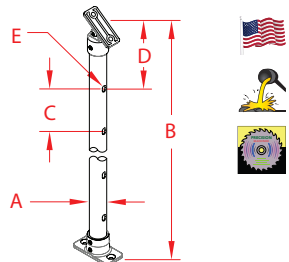

ITEM	A	B	C	D	E	WT
						(lb)
S0950-S060	1"	42.00"	3.00"	3.00"	0.27"	2.90

NOTE:
The Cable Stabilizer Stair Kit is designed specifically for stairs where post to post measurement spans over 4'. It enables you to adapt longer spans to code compliance by stabilizing the deflection of cable between posts. Each kit comes with a 42" stanchion pre-drilled to work with our standard 3" spacing. In most cases, stanchions must be field cut at both ends for an accurate fit. The Cable Stabilizer Stair Kit cannot be used to replace the use of substantial mid posts and should never be used in spans over 7'. Kit includes fasteners.
SEE ADDITIONAL INFORMATION BELOW.

ALUMINUM CABLE STABILIZER KIT

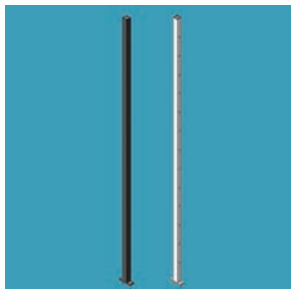

ALUMINUM

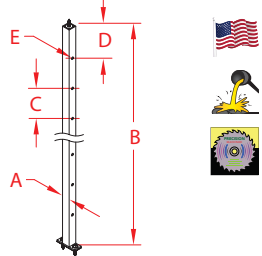

ITEM	A	B	C	D	E	COLOR	WT
							(lb)
A0908-BK60	0.76"	42.00"	3.00"	3.00"	0.22"	Black	0.91
A0908-WH60	0.76"	42.00"	3.00"	3.00"	0.22"	White	0.91
CABLE GROMMET*	CABLE	HOLE SIZE	QUANTITY				
C0916-A003-25	1/8"	7/32"	25				
C0916-0004-25	5/32"	7/32"	25				

NOTE:
Do not install within 1 mile of salt water. Stabilizer kit is designed specifically for use where post to post measurement spans over 4'. Each kit comes with a 42" stanchion, mounting hardware, 3" hole spacing and fasteners. Cut at both ends for an accurate fit. Kit cannot be used to replace the use of a substantial mid post and should never be used in spans over 7'. *Grommets required for install.
SEE ADDITIONAL INFORMATION BELOW.

CABLE STABILIZER SAFETY INFORMATION & REQUIREMENTS

Atlantis Rail Cable Stabilizers are purposed for use in maintaining code compliant cable spacing between post and rail sections with spacing greater than 4 feet between posts and not exceeding 7 feet. **The Cable Stabilizer is not a structural component and is not a substitute for a post!** Post and rail structure where a cable stabilizer is used should be rated and built to be structural without a cable stabilizer per building code requirements. Do not rely on the cable stabilizer to support the rail or add stability. The only function of the cable stabilizer is to maintain cable spacing. Building the railing to an appropriate code compliant structure is the sole responsibility of the user of Atlantis Rail products.

REQUIREMENTS & MAXIMUM LENGTHS FOR USING ATLANTIS RAIL CABLE STABILIZERS

Spectrum System: The cable stabilizer may be used with sections up to 6 feet (between posts) if all other Spectrum specifications are properly implemented.
RailEasy™ Nautilus System: The cable stabilizer may be used with sections up to 6 feet (between posts) if all other RailEasy™ Nautilus specifications are properly implemented.
SunRail™ Nautilus System: The cable stabilizer may be used with sections up to 6 feet (between posts) if all other SunRail™ Nautilus specifications are properly implemented.
Other Atlantis Rail Systems: Consult the manufacturers' specifications for the length of rail that is considered structural. The cable stabilizer may be used with composite, metal, vinyl or structural wood frame systems up to the calculated code rated spacing of the system or a maximum of 7 feet, whichever is less.



Spectrum

Railing System

A Square Post System With Many Options COST:    

The Spectrum System features pre-drilled square posts and fittings to surface or fascia mount the posts and mount handrails. The cable infill offers a choice between using 1/8" or 5/32" cable with HandiSwage™ Studs. You can find installation instructions at www.atlantisrail.com or by asking your Atlantis Rail Sales Representative for more information. Customers must source their own flat handrail. Choose from the colors below.



COLOR SELECTION

- STANDARD**  
- SPECIAL**    

Colors from top, left to right: Black, Metallic Silver, Pure White, Pebble Grey, Brown and Deep Red.

**Uncoated option available upon request.*

CABLE INFILL OPTION

HandiSwage™

The Spectrum System is available using a 5/32" or 1/8" diameter cable and HandiSwage™ Studs, making it one of the simplest and most economical cable railing systems available. All the studs, cable and accessories are made from electro-polished 316L stainless steel for maximum corrosion resistance and durability. For a finished look, we offer a variety of cover nut sets including multiple styles and colors.



SPECTRUM SYSTEM



ADA HANDRAIL MOUNTING BRACKET

The ADA Handrail Mounting Bracket features a clamp that fits onto a Spectrum post and allows for the attachment of rail end and mid support fittings. These supports accept a 1-1/2" stainless steel tube which enables the Spectrum System to be ADA compliant. The clamp is powder-coated to match the post color.



S0904-XX60* (clamp) & S0901-0401 (rail mid support)

REINFORCING CHANNEL

This channel is used in applications where the handrail needs additional structural reinforcement. It fits over the Top Mounting Plate Assembly and the screws can be mounted through the slots running the length of the channel and into the handrail. The Reinforcing Channel is powder-coated to match the post color and available in 48" lengths and can be cut to size. The 36" surface mount post requires a spacing block (S0904-XX58*). Spacing block sold separately with fasteners.



S0904-XX54*

WIDE MOUNTING PLATE

The Wide Mounting Plate is twice the width of the standard mounting plate and is used in applications where a wider top rail is desired. The plate is powder-coated to match the post color. Additional wood screws are included.

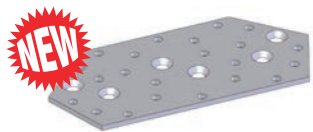

S0904-XX53*

* "XX" in the part number is the color designation. Replace with "BK" for black, "MT" for metallic silver or "SP" for one of the special colors.

POST KIT COMPONENTS

Spectrum surface mount & fascia mount post kits and stabilizer kits include the following components:



SURFACE MOUNT POSTS

- 1 - Square Post
- 1 - Top Mounting Plate Assembly
- 4 - Lag Screws (to surface mount post)
- 4 - Lag Screw Caps
- 1 - Base Cover

FASCIA MOUNT POSTS

- 1 - Square Post
- 1 - Top Mounting Plate Assembly
- 1 - Plastic Bottom Cap
- 3 - Lag Screws (to fascia mount post)
- 3 - Lag Screw Caps

CABLE STABILIZER KITS

- 1 - Cable Stabilizer
- 4 - Lag Screws
- Use with surface mount Spectrum posts only.

Refer to Spectrum System installation instructions for more details.

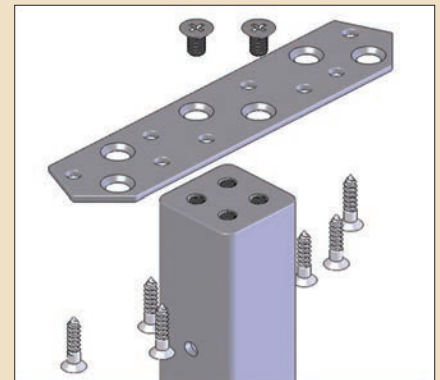

Top Mounting Plate Assembly (fasteners included)

This assembly allows for the easy installation of a customer supplied flat top rail. Each plate is precision machined with matching hole patterns for easy installation to posts and handrails. A stainless plate is fastened to the post and wood screws are then drilled up into the top rail.

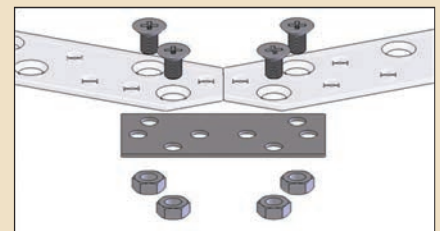

Corner Mending Plate Set - S0904-XX51* (fasteners included)

This set is used to join Top Mounting Plate Assemblies on corner posts. The hole patterns match those of the Mounting Plate and attach using the 1/4" screws and nuts.



The mounting plates feature angled ends which allow installers to meet 90° or 135° angles at corners. Corners require double posts.

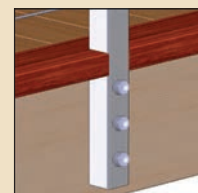

Stainless Lag Screws (5/16" x 4-1/2") and Lag Screw Caps are included in kits for fascia mount posts.

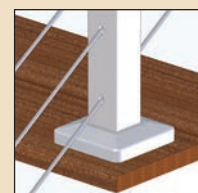

The base cover can be added once the surface mount post is secured for a finished look.



NOVA SYSTEMS

Cable Railing with Powder-Coated Aluminum Posts & Rails

The NOVA Systems feature powder-coated aluminum posts, handrails and foot rails and horizontal cable infill. The cable infill utilizes HandiSwage™ fittings with 1/8" cable.

Atlantis Rail offers two aluminum cable railing systems, NOVA and NOVA II. These systems are completely off-the-shelf and feature minimal components. The major differences between the systems include, handrail profiles, color options, height options, cap and skirt styles and rail mounting hardware. Each post and rail kit includes everything needed for installation. Post mounting hardware, cable and cable mounting hardware are sold separately.

The NOVA Systems are not to be installed within 1 mile of salt water.

COST: \$ \$ \$ \$



SURFACE MOUNTING

The NOVA posts are surface mounted using the NOVA Post Mounting Hardware Kit. This kit includes 4, 5/16" x 4-1/2" hex head lag bolts and accompanying cover nuts. Customers must source their own mounting hardware when mounting on surfaces other than wood.

HandiSwage™ CABLE INFILL

The NOVA Systems feature 1/8" diameter cable and a line of HandiSwage™ fittings including studs and tensioners. Using the HandiSwage™ line, makes the NOVA Systems one of the simplest and most economical cable railing systems available. All fittings cable and accessories are made from electro-polished, 316L stainless steel for maximum corrosion resistance and durability. For a finished look, we offer cover nuts sets to match the posts.



NOVA II SYSTEM RAIL KITS

There are 2 types of NOVA II rail kits; a straight and stair kit. They are offered in 6' lengths utilizing a top and bottom rail and a cable stabilizer. Each kit includes all the necessary fasteners and components to mount the rails to the NOVA II posts.

STRAIGHT RAIL KIT

NOVA II 6' Straight Rail Section A0906-0201-XX*

Includes the following components:

- 1 Top Rail
- 1 Bottom Rail
- 1 Cable Stabilizer, Drilled
- 2 Top Rail Brackets
- 4 Screw Covers
- 2 Bracket Keys
- 4 Button Head Screws
- 2 Bottom Rail Brackets
- 1 Support Block
- 13 Self-Drilling Screws
- 1 Support Block Base Lot
- 3 Connectors
- 1 Square Driver Bit



STAIR RAIL KIT

NOVA II 6' Stair Rail Section A0906-S021-XX*

Includes the following components:

- 1 Top Stair Rail
- 1 Bottom Stair Rail
- 1 Cable Stabilizer, Undrilled
- 1 Upper Stair Rail Bracket
- 1 Lower Stair Rail Bracket
- 2 Top Stair Rail Bracket Mounts
- 2 Bottom Stair Rail Brackets
- 2 Bottom Stair Rail Bracket Mounts
- 1 Support Block
- 13 Self-Drilling Screws
- 8 Set Screws
- 1 Support Block Base Kit
- 3 Angled Connectors
- 1 Square Driver Bit

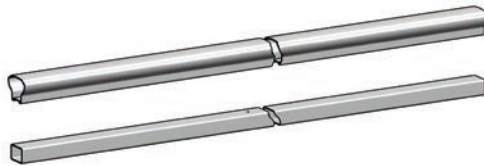

NOVA II SYSTEM POST KITS

The NOVA II System has 6 post kits including a 36" and 42" universal and a 36" and 42" corner post for level sections and a 36" and 42" post for stair sections. The post kits for level sections are pre-drilled, while the stair post kits are undrilled due to stair variables. Each kit includes everything needed for installation, excluding post mounting hardware. For mounting to wood, use the NOVA Post Mounting Hardware Kit (A0908-HD10).

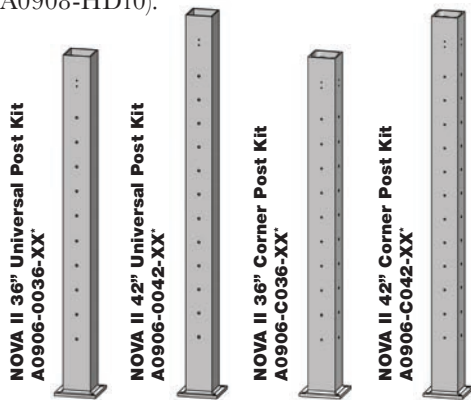

LEVEL POST KITS

Included in the Universal and Corner Post Kits:

- 1 Post, Drilled
- 1 Post Skirt
- 1 Post Cap
- 1 Post Pad

Additional items included in the Corner Post Kits:

- 10 or 12 NOVA HandiSwage™ Studs
- 10 or 12 Plastic Washers
- 10 or 12 Cable Grommets



STAIR POST KITS

Included in the 36" & 42" Undrilled Stair Post Kits:

- 1 Post, Undrilled
- 1 Post Skirt
- 1 Post Cap
- 1 Post Pad

* "XX" in the part number is the color designation. Replace with "BK" for black, "WH" for white or "BZ" for bronze.

NOVA II SPECS & OPTIONS

Below are the major differences between the NOVA Systems.

NOVA II Colors Available

Black, White & Bronze.



36" or 42" Rail Height



NOVA II Handrail Profile

NOVA II Post Cap



NOVA II Post Skirt

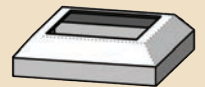

NOVA & NOVA II ACCESSORIES



NOVA Tensioner Backing Disk – A0908-TB04-10

This backing disk is used in conjunction with the HandiSwage™ Tensioner. Available in packs of ten.



NOVA Cover Nut Set – C0906-XX02-10 and C0906-XX02-12

The NOVA Cover Nut Set includes a plastic washer, stainless steel nut and plastic cover nut. It is used with the HandiSwage™ Stud for tensioning capabilities. Available in black, white and bronze colors in packs of ten or twelve.

NOVA SPECS & OPTIONS

Below are the major differences between the NOVA Systems.

NOVA Colors Available: Black



36" Rail Height



NOVA Handrail Profile

NOVA Post Cap



NOVA Post Skirt

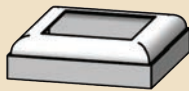

NOVA & NOVA II GROMMETS

Grommets help prevent movement and deflection of the cable, as well as, reduce dirt and moisture from getting inside the posts. The grommets shown below are available in packs of twenty five.

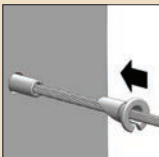

NOVA End/Corner Grommet – C0916-B003-25

These grommets are used on end and corner level posts. It fits over the HandiSwage™ Stud.



NOVA Mid Grommet – C0916-0003-25

These grommets are used on the universal level posts where the cable is passing through (not terminating with a HandiSwage™ Stud).

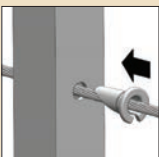

Universal Stabilizer Mid Grommet – C0916-A003-25

These grommets are used on cable stabilizer level sections.

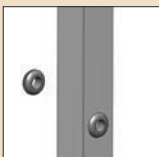

NOVA Stair Post & Stabilizer Grommet – A0908-SG01-25

These grommets are used on stair mid posts and stabilizers and must be put on BEFORE the cable is run through.

NOVA SYSTEM RAIL KITS

The NOVA rails include a straight and stair kit. They are offered in 6' lengths utilizing a top and bottom rail and a cable stabilizer. Each kit includes all the necessary fasteners, and components to mount the rails to the NOVA posts.

STRAIGHT RAIL KIT

NOVA 6' Straight Rail Section A0908-0201

Includes the following components:

- 1 Top Rail
- 1 Bottom Rail
- 2 Saddle Brackets
- 2 Bracket Covers
- 2 Bottom Brackets
- 1 Cable Stabilizer, Drilled
- 1 Support Block
- 2 Extra Connectors
- 12 Self-Drilling Screws
- 1 Square Driver Bit
- 1 Adhesive Tab
- 1 Support Block Base Kit



STAIR RAIL KIT

NOVA 6' Stair Rail Section A0908-S021

Includes the following components:

- 1 Top Rail
- 1 Bottom Rail
- 1 Upper Saddle Bracket
- 1 Lower Saddle Bracket
- 2 Bracket Covers
- 1 Upper Bottom Bracket
- 1 Lower Bottom Bracket
- 1 Cable Stabilizer, Undrilled
- 1 Support Block
- 4 Connectors (Block & Stabilizer)
- 14 Self-Drilling Screws
- 1 Square Driver Bit
- 1 Adhesive Tab
- 1 Support Block Base Kit



NOVA SYSTEM POST KITS

The NOVA System has 4 post kits including a universal and corner post for level sections and a top/mid and bottom post for stair sections. The post kits for level sections are predrilled, while the stair post kits are undrilled due to stair variables. Each kit includes everything needed for installation, excluding post mounting hardware. For mounting to wood, use the NOVA Post Mounting Hardware Kit (A0908-HD10).



NOVA 36" Universal Post Kit
A0908-0036

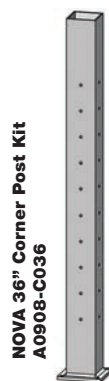

NOVA 36" Corner Post Kit
A0908-C036



NOVA 36" Undrilled Stair Post Kit
(Top & Mid Posts) A0908-U036

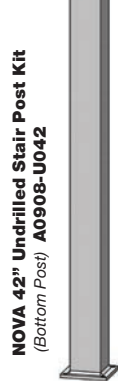

NOVA 42" Undrilled Stair Post Kit
(Bottom Post) A0908-U042

LEVEL POST KITS

Included in the Universal and Corner Post Kits:

- 1 Post, Drilled
- 1 Post Skirt
- 1 Post Cap
- 1 ACQ Pad

Additional items included in the Corner Post Kit:

- 1 Corner Post Insert
- 10 NOVA HandiSwage™ Studs
- 10 Plastic Washers, Black
- 10 Cable Grommets

STAIR POST KITS

Included in the 36" & 42" Undrilled Stair Post Kits:

- 1 Post, Undrilled
- 1 Post Skirt
- 1 Post Cap
- 1 ACQ Pad



COST: \$ \$ \$ \$

HANDISWAGE™ CABLE RAILING

A Revolutionary Approach to the Conventional

Atlantis Rail's HandiSwage™ System is an easy to use cable railing product utilizing fittings that are an adaptation of traditional swage fittings. They can be attached to cable using Atlantis Rail's hand swage tool. This system combines the aesthetic appeal, quality and durability of the RailEasy™ cable railing components with the convenience and economy of 1/8" and 5/32" cable. All HandiSwage™ components are made from grade 316L stainless steel for durability and corrosion resistance.

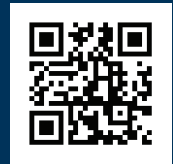

Scan for more information or visit:
www.handiswage.com



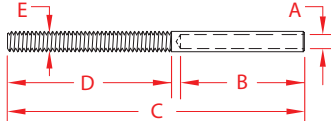

HANDISWAGE™ STUDS
UNF - 316L STAINLESS STEEL

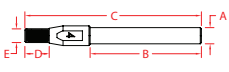

ITEM	A	B	C	D	E	QTY.	WT
	(cable)				(thread)		(lb)
STANDARD - 2 PACK							
C0731-H0703-2	1/8"	1.51"	3.62"	2.00"	0.25"	2	0.07
C0731-H0704-2	5/32"	1.51"	3.62"	2.00"	0.25"	2	0.07
SHORT (BELOW)							
S0731-HM0703	1/8"	1.51"	2.56"	0.44"	0.25"	1	0.02
NOTE: DESIGNED FOR HAND SWAGE USE ONLY. Threads are "UNF". Crimp HandiSwage™ Studs onto cable using the Hand Swager.							
					HANDISWAGE™		

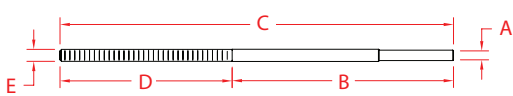
HANDISWAGE™ LONG STUD
UNF - 316L STAINLESS STEEL



ITEM	A	B	C	D	E	QTY.	WT
	(cable)				(thread)		(lb)
2 PACK							
C0731-HL703-2	1/8"	4.50"	8.00"	3.50"	0.25"	2	0.18
NOTE: DESIGNED FOR HAND SWAGE USE ONLY. The HandiSwage™ Long Stud is perfect for architectural cable railing applications where "through post" hardware is desired for minimal obstruction. Threads are "UNF". Crimp HandiSwage™ Studs onto cable using the Hand Swager (E0113-H600).							
		"30, 34 or 38 DEGREE STAIR SPACERS (2 PACK)" Use in conjunction with the HandiSwage™ Long Stud to achieve angled cable runs on stairs. Install one of our cover nut options (sold separately) on the end of the threaded stud for a finished look.			HANDISWAGE™		

HANDISWAGE™ LAG STUD
316L STAINLESS STEEL

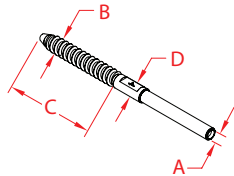

ITEM	A	B	C	D	WT
	(cable)				(lb)
INDIVIDUAL					
S0747-HR03	1/8"	0.28"	1.73"	0.19"	0.04
NOTE: DESIGNED FOR HAND SWAGE USE ONLY. The HandiSwage™ Lag Stud is designed for use in short runs and must always be used with a tensioning device at the opposite end of the cable run. These fittings are made from grade 316L stainless steel for corrosion resistance and durability. Crimp the lag stud onto cable using the Hand Swager (E0113-H600).					
HANDISWAGE™					

HANDISWAGE™ TENSIONER
316L STAINLESS STEEL

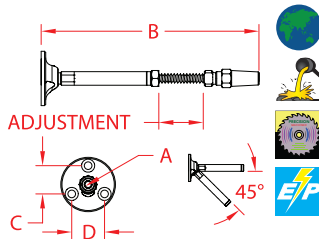

ITEM	A	B	C	D	ADJ.	QTY.	WT
	(cable)						(lb)
2 PACK							
C0748-0003-2	1/8"	5.40"	0.78"	0.90"	1.35"	2	0.37
NOTE: DESIGNED FOR HAND SWAGE USE ONLY. The HandiSwage™ Tensioner is used in architectural cable railing applications. This tensioner is made from grade 316L stainless steel for corrosion resistance and durability. It features a slotted base to achieve angles up to 45 degrees. Compression fitting allows for tensioning with simple hand tools. Fasteners included.							
HANDISWAGE™							

HANDISWAGE™ FLUSH FITTING
316L STAINLESS STEEL

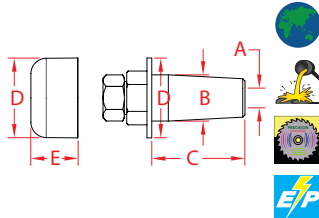

ITEM	A	B	C	D	E	QTY.	WT
	(cable)						(lb)
2 PACK							
C0981-P003-2	1/8"	0.43"	0.84"	0.75"	0.45"	2	0.10
NOTE: The HandiSwage™ Flush Cable Fitting is perfect for architectural cable railing applications where "through post" hardware is desired for minimal obstruction. Fitting uses mechanical swage design to attach to cable. Affix the supplied stainless steel deluxe cap to the end for a finished look.							
HANDISWAGE™							

HANDISWAGE™ CABLE

316L STAINLESS STEEL

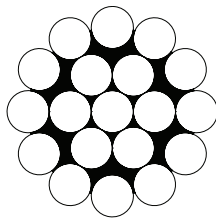
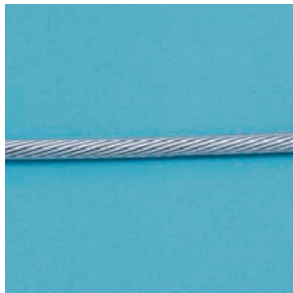

ITEM	SIZE	SPOOL	WT
			(lb)
S0701-0003	1/8"	CUTS	4.00*
S0701-0003-01	1/8"	100'	4.80
S0701-0003-02	1/8"	250'	10.80

NOTE:

1x19 construction, left hand lay and made from grade 316L stainless steel for maximum corrosion resistance and durability. Spools are available in 100' or 250' lengths. Custom spools are available upon request.

* = Weight per 100' in pounds, without reel.
Spool weight includes reel.

HANDISWAGE™

HANDISWAGE™ CABLE SLEEVE

316L STAINLESS STEEL

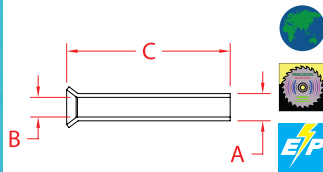

ITEM	A	B	C	QTY.	WT
					(lb)
10 PACK					
C0915-0338	0.22"	0.15"	1.50"	10	0.08

NOTE:

The HandiSwage™ Cable Sleeve is designed to protect your wood posts from chafing and incidental damage from cable rubbing around the outside of your mid post cable holes. It can also be used to accommodate angles up to 90 degrees and stairways coming off a straight run.



E0114-0000 - CABLE GRIP PAD (3 PACK)

Use a Cable Grip Pad with vice grips when tensioning the cable. Place a pad on the cable and apply the vice action to the pliers to keep cable from rotating while you tension the stud.

HANDISWAGE™

HAND SWAGER

FOR USE WITH HANDISWAGE™ SERIES ONLY



ITEM	SIZE	SWAGES	WT
	(length)		(lb)
E0113-H600	24"	1/8", 5/32" and 3/16"	6.35

NOTE:

Make hand swaging quick and easy using our Hand Swager. Crimps HandiSwage™ fittings onto cable. After Swage Gauge included.



E0113-HG00 - AFTER SWAGE GAUGE

Use this gauge to confirm that the "after swage" dimension of each HandiSwage™ fitting is correct. The After Swage Gauge is designed to measure 1/8", 5/32" and 3/16" fittings.

HANDISWAGE™

STAINLESS NUT SETS

316 STAINLESS STEEL

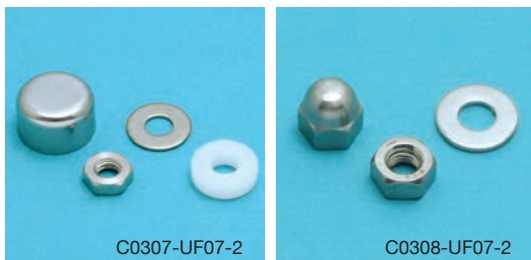

ITEM	SIZE	WIDTH	DEPTH	THREAD	QTY.	WT
	(thread)					(lb)
DELUXE COVER NUT SET - 2 PACK						
C0307-UF07-2	1/4"	0.75"	0.40"	Right Hand/UNF	2	0.04
ACORN NUT SET - 2 PACK						
C0308-UF07-2	1/4"	0.44"	0.47"	Right Hand/UNF	2	0.04

NOTE:

Designed for use with HandiSwage™ Studs and RailEasy™ Stud Assembly. Stainless Nut Sets are perfect for cable railing systems where "through-post" hardware is desired for minimal obstruction. Affix to end of stud for a finished look.

HANDISWAGE™

HANDISWAGE™ COVER NUT SETS

316 STAINLESS STEEL & PLASTIC



ITEM	SIZE	WIDTH	DEPTH	THREAD	QTY.	WT
	(thread)					(lb)
BLACK - 10 PACK						
C0309-BK02-10	1/4"	0.69"	0.42"	Right Hand/UNF	10	0.10
BROWN - 10 PACK						
C0309-BR02-10	1/4"	0.69"	0.42"	Right Hand/UNF	10	0.10
METALLIC SILVER - 10 PACK						
C0309-MT02-10	1/4"	0.69"	0.42"	Right Hand/UNF	10	0.10
WHITE - 10 PACK						
C0309-WH02-10	1/4"	0.69"	0.42"	Right Hand/UNF	10	0.10

NOTE: Designed for use with HandiSwage™ Studs and RailEasy™ Stud Assembly. Cover Nut Sets are perfect for cable railing systems where "through-post" hardware is desired for minimal obstruction. Affix to end of stud for a finished look.

HANDISWAGE™



SUNRAIL™ SYSTEM

Complete Stainless Steel Modular Railing System

COST: (\$ (\$ (\$ (\$

For a completely stainless steel railing system, Atlantis Rail offers the SunRail™ systems. These modular systems allow for easy installation while achieving a custom look. The SunRail™ models are available with infill options of cable railing, glass panels and ADA compliant handicap railing systems. The streamlined look of these systems provides the enjoyment of unobstructed views without compromising the structural integrity.



SunRail™ Systems.....24-27

- Residential.....25
- Commercial.....26
- Custom.....27
- ADA Compliant.....27

SunRail™ Latitude.....28-29

- Cable Railing Infill.....28
- Latitude Post Kits.....29



We invite you to visit our website to learn more about the SunRail™ Systems. Installation instructions and a complete photo gallery are available online.



RESIDENTIAL

Enjoy years of long lasting value with a low maintenance stainless railing system.

Achieve a custom look at a fraction of a fabricators' cost. These modular systems are perfect for any indoor or outdoor design and are pre-engineered for a quick and easy installation. The SunRail systems' modular components are made from marine grade 316L stainless steel for maximum corrosion resistance and durability.

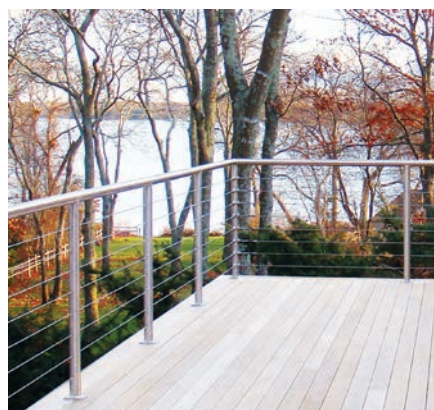
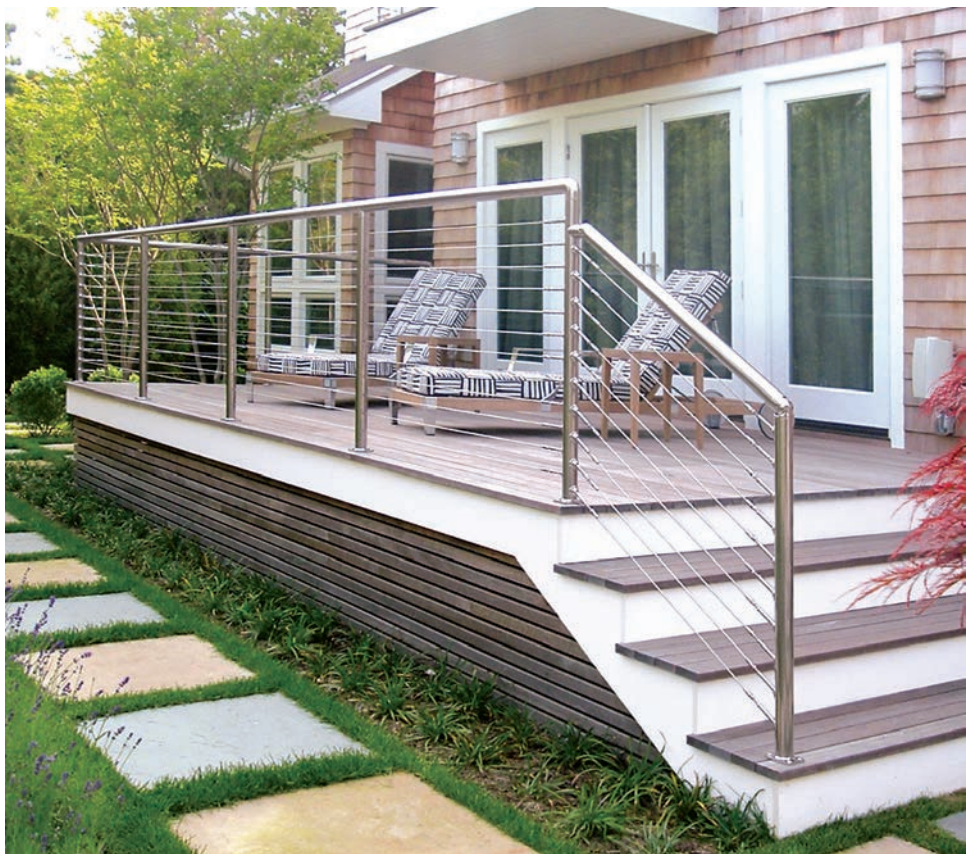

The SunRail™ systems blend nicely with any style residence and can be used for interior or exterior applications.

The SunRail™ Systems are modular stainless steel railing systems that are ideal for any indoor or outdoor residential design. Each railing is pre-engineered for quick and easy installation with infill options of cable railing and glass panels. The versatility of a highly polished or brushed finish allows the SunRail™ models to blend nicely with every environment.



Visit the **Railing Gallery** to find inspiration and see what other homeowners have designed using the SunRail™ systems.



RailEasy™ Nautilus



SunRail™ Nautilus

COMMERCIAL

Stainless steel modular components offer versatility to fit many commercial needs.

Atlantis Rail offers the versatility of completely stainless steel systems or railings that integrate wood, composite or vinyl. Horizontal cable railing and glass panels are available as railing infill, as well as, your choice of a brushed or highly polished stainless steel finish. These railings are made from grade 316L stainless and electro-polished to offer maximum corrosion resistance and durability, making them ideal for outdoor and oceanfront applications. Let Atlantis Rail satisfy your commercial needs with a cost effective and unique railing system.



SunRail™ Nautilus



SunRail™ Nautilus



SunRail™ Glass



We invite you to visit our website to learn more about our **Commercial Railing** selection. Atlantis Rail Engineers will work with you to create a stainless steel railing system second to none!



Gates

CUSTOM



Custom w/ Balusters

All Atlantis Rail systems feature modular components to allow for customization in any size indoor or outdoor project.

Atlantis' team of Engineers work with you to design a railing system that fits you or your customers' needs. With the help of our knowledgeable staff and our state-of-the-art machinery, we are able to easily customize both the SunRail™ and RailEasy™ systems. For subtle illumination, add Micro Star™ LED lighting to any railing project. These super bright white LED lights are ideal for accenting indoor or outdoor railing applications. The small size and easy installation allows for endless design possibilities.



Custom Mounting



ADA Compliant



ADA Compliant Systems SunRail™ Custom

The versatility of our SunRail™ system allows us to provide ADA compliant railing systems “made to order”. The patented, modular components allow for the quick and accurate production of railings for any size project. Cable railing and glass panels are offered as infill options, as well as, your choice of a brushed or highly polished stainless steel finish. Let Atlantis Rail provide you with a cost effective and unique alternative for those with disabilities.

SUNRAIL™ LATITUDE

New Look... Same Unobstructed View

COST: \$ \$ \$ \$

The SunRail™ Latitude features prefabricated 316L stainless steel posts and horizontal cable infill, utilizing RailEasy™ round base tensioners and top rail mounting plates. These top rail mounting plates offer easy installation with virtually no hardware obstruction and allows customers to select their desired top rail.



CABLE RAILING INFILL

The SunRail™ Latitude System is comprised of mechanical swage tensioners riveted to 2" outer diameter stainless steel posts to allow for cable railing infill. These RailEasy™ Tensioners feature a compression fitting which enables installers to cut cable on-site, removing the hassle of pre-measuring and the cost of miscalculating dimensions. The cable used is a 5/32" diameter 1x19 strand cable. All fittings, cable and accessories are made from 316L stainless steel for maximum corrosion resistance. Standard cable spacing is less than 3" on-center.

HOW TO ORDER

The SunRail™ Latitude can be purchased through a local authorized Atlantis Rail Dealer. To find a dealer near you, please visit the Dealer Locator on the Atlantis Rail website. You can also fax (508) 732-9798 or email info@atlantisrail.com a plan view layout with simple dimensions to Atlantis Rail for a quote. Call or click today to learn more about the SunRail™ Latitude System.



SUNRAIL™ LATITUDE POST KITS

For easy ordering, the SunRail™ Latitude is offered as 3 post kit options in a 36" or 42" railing height. The post kits available are end posts, mid posts and corner posts. All post kits feature a 316L stainless steel 2" outer diameter tubular post in a polished finish. Cable spacing varies depending on post kit model. Consult installation instructions for complete details.

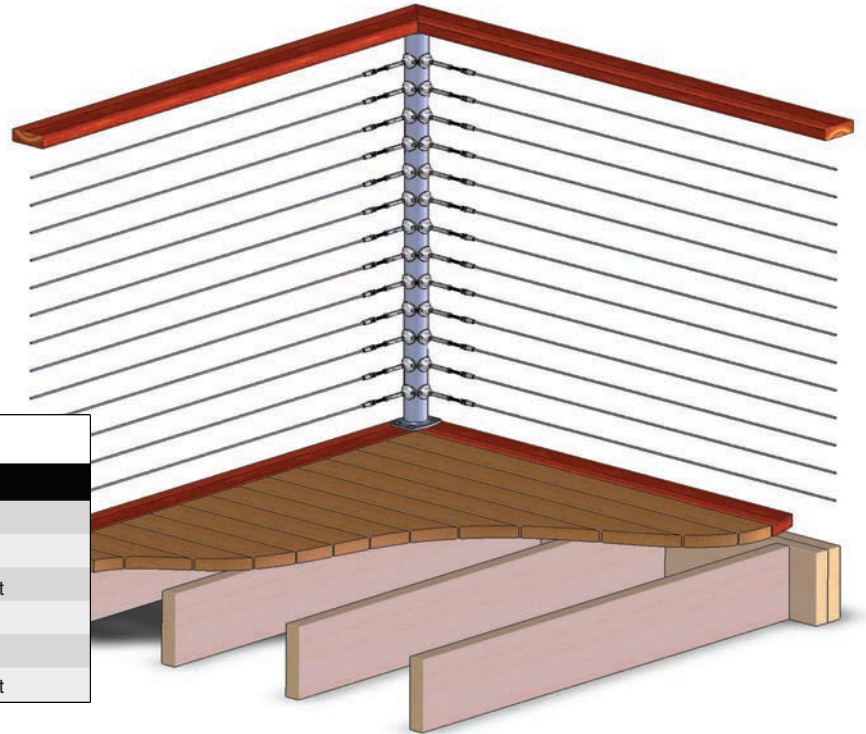

SunRail™ Latitude Components	
PART NUMBER	DESCRIPTION
S0952-E036	SunRail™ Latitude 36" End Post Kit
S0952-M036	SunRail™ Latitude 36" Mid Post Kit
S0952-C036	SunRail™ Latitude 36" Corner Post Kit
S0952-E042	SunRail™ Latitude 42" End Post Kit
S0952-M042	SunRail™ Latitude 42" Mid Post Kit
S0952-C042	SunRail™ Latitude 42" Corner Post Kit



End Post Kits:

- 36" or 42" tube
- Top Plate Mounting Assembly (fasteners included)
- Mounting base (fasteners not included)
- 11 or 13 RailEasy™ Tensioners Round (depending on height)

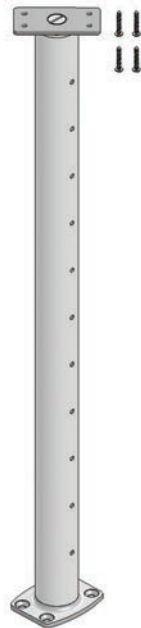

Mid Post Kits:

- 36" or 42" tube
- Top Plate Mounting Assembly (fasteners included)
- Mounting base (fasteners not included)
- 11 or 13 pre-drilled holes for running cable



Corner Post Kits (for 90° corners):

- 36" or 42" tube
- Top Plate Mounting Assembly (fasteners included)
- Mounting base (fasteners not included)
- 22 or 26 RailEasy™ Tensioners Round (depending on height)

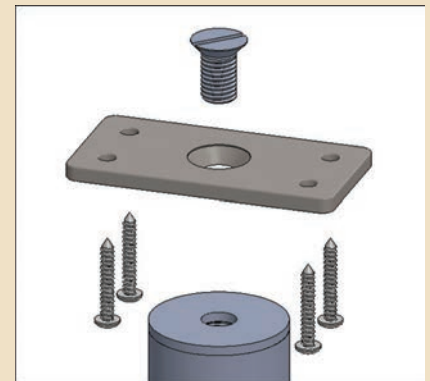

Top Plate Mounting Assembly

This assembly allows for the easy installation of a customer supplied flat top rail. A cap is pre-welded to the post which is then fastened to a stainless plate. Wood screws are drilled up into the top rail.

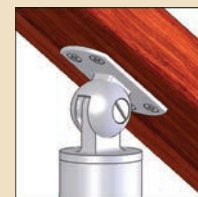

Stair Fitting

S0902-0409

The SunRail™ Latitude has the ability to fit any design situation including stair and fascia mounting applications.

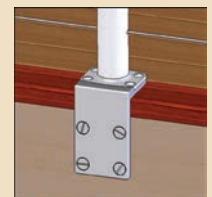

Fascia Mount

S0950-0002



RailEasy™ Glass



SunRail™ Glass

GLASS SYSTEMS COST: \$ \$ \$ \$

PRODUCT INFORMATION

Straight Sections

Atlantis Rail offers standard rail heights of 36" or 42" for straight sections.

Note: Atlantis Rail Systems does not supply glass panels for these systems.

Stair Sections

Rail height for stair sections are available in 36" only.

Note: Railing heights are offered in these dimensions due to nationwide building codes. However, Atlantis Rail can accommodate custom heights/lengths upon request.

Between Posts Length

Atlantis Rail Systems recommends staying within 5' section lengths to maintain structural integrity.



Glass System Options

Atlantis Rail offers a variety of glass panel connector styles to fit tubular and flat posts and rails. The contoured glass panel connectors fit a 2" stainless steel tube which can be used with the RailEasy™ or SunRail™ Glass Systems. The flat glass panel connector is ideal for integrating glass into a wood post and rail system or into a Spectrum System. The Glass Panel Base can be used on many applications including the Spectrum System with no top rail for a completely unobstructed view.

SPECIFICATIONS

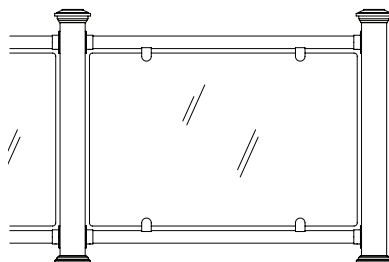

36" RAILEASY™ GLASS

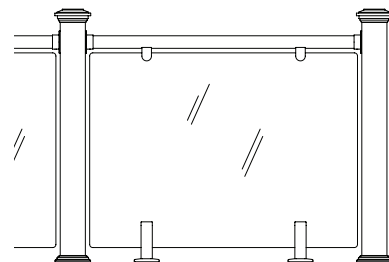

36" RAILEASY™ GLASS WITH GLASS PANEL BASES (S0925-0010)

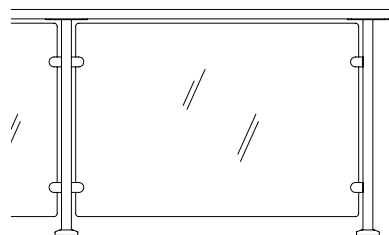

36" SPECTRUM GLASS WITH FLAT BASE GLASS PANEL CONNECTORS (S0950-F010)

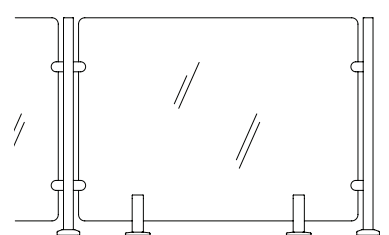

SPECTRUM GLASS WITHOUT TOP RAIL

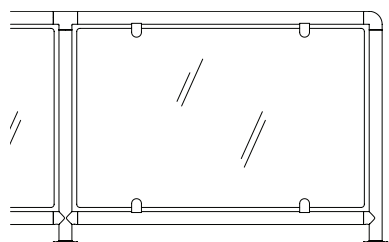

SUNRAIL™ GLASS

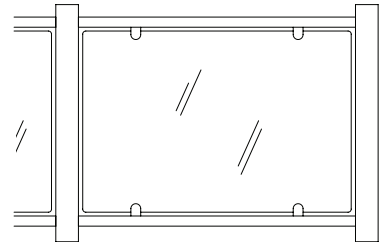

WOOD POSTS AND RAILS WITH FLAT GLASS PANEL CONNECTORS (S0950-F010)

RAILEASY™ GLASS PANEL KIT

316L STAINLESS STEEL

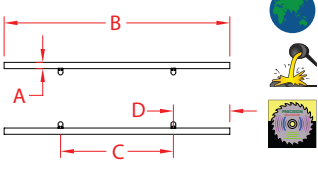



ITEM	A	B	C	D	CONNECTORS	WT
						(# on each rail)
						(lb)
POLISHED						
C0925-1200	2.00"	48.00"	24.00"	12.00"	2	12.32
C0925-1500	2.00"	60.00"	30.00"	15.00"	2	14.80
C0925-1800	2.00"	72.00"	24.00"	12.00"	3	18.48
BRUSHED						
C0925-1200-B	2.00"	48.00"	24.00"	12.00"	2	12.32
C0925-1500-B	2.00"	60.00"	30.00"	15.00"	2	14.80
C0925-1800-B	2.00"	72.00"	24.00"	12.00"	3	18.48

NOTE:
Kit includes a highly polished or brushed top and bottom rail in 4, 5 or 6 foot lengths. Two or three Glass Panel Connectors (S0950-0010) are pre-attached to the tubing. Connectors open on one side to allow glass to be positioned between neoprene pads (included).

GLASS PANEL CONNECTOR - 1/2"

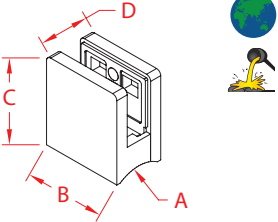
316 STAINLESS STEEL

ITEM	SIZE	A	B	C	D	WT
						(lb)
POLISHED						
S0950-0013	2"	2.00"	2.13"	2.33"	3/8"-1/2"	1.00
BRUSHED						
S0950-0013-B	2"	2.00"	2.13"	2.33"	3/8"-1/2"	1.00

NOTE:
Heavy duty version used for 3/8" to 1/2" thick glass. Connector back is specially shaped to fit the outside of 2" tubing and attached by a screw into a rivet nut placed into the tubing (both not included); bolt and rivet are hidden by the connector.

Connector opens on one side after installation to allow glass to be positioned between neoprene pads (included). Rivets and fixing screws are supplied with complete rail systems.

GLASS PANEL CONNECTOR - 3/8"

316 STAINLESS STEEL

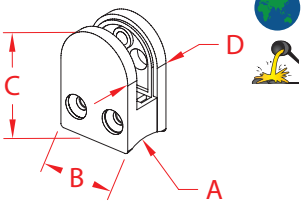
ITEM	SIZE	A	B	C	D	WT
						(lb)
POLISHED						
S0950-0010	2"	2.00"	1.52"	2.09"	3/8"	0.40
BRUSHED						
S0950-0010-B	2"	2.00"	1.52"	2.09"	3/8"	0.40

NOTE:
Strong but smaller version used for 5/16" to 3/8" glass. Connector back is specially shaped to fit the outside of 2" tubing and attached by a screw into a rivet nut placed into the tubing (both not included); bolt and rivet are hidden by the connector.

Connector opens on one side after installation to allow glass to be positioned between neoprene pads (included). Rivets and fixing screws are supplied with complete rail systems.

GLASS PANEL CONNECTOR - FLAT

316 STAINLESS STEEL

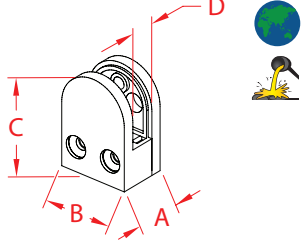



ITEM	A	B	C	D	WT	
						(lb)
POLISHED						
S0950-F010	1.10"	1.57"	1.97"	3/8 - 1/2"	0.46	

NOTE:
Heavy duty version used for 3/8" to 1/2" thick glass. Connector is flat to mount to any flat surface including Spectrum posts. Connector opens on one side after installation to allow glass to be positioned between neoprene pads (included).

GLASS PANEL BASE

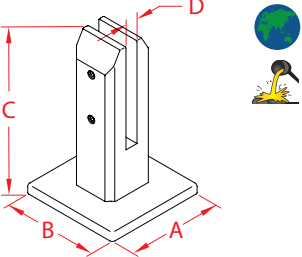
316 STAINLESS STEEL

ITEM	A	B	C	D	WT	
						(lb)
POLISHED						
S0925-0010	3.96"	3.96"	6.36"	3/8" - 1/2"	3.87	

NOTE:
Heavy duty glass panel base is used for 3/8" to 1/2" thick glass. Base is mounted with 4 fasteners (not included) and a skirt is placed on top for a finished look. A plastic insert (supplied) fits inside and wraps around glass. Set screws (supplied) hold the glass in place. Additional plastic wedges are included to give the glass a snug fit.

micro star™ Lighting

The Micro Star™ series is both a functional and a creative lighting alternative. They can be used on railings, decks, fences, steps and many more interior or exterior lighting applications.

Accent Features

The patented Micro Star™ series is a complete line of lighting options for railings, fencing, steps and many other indoor or outdoor applications. The Micro Star™ LED Lights are available in 12v and each draws only .02 amps. Each bulb has a lifecycle of 25,000 hours. The Micro Star™ LED Post Cap provides sufficient levels of lighting and fits over standard 4" x 4" vinyl sleeves. They are pre-wired for simple connection and quick installation.

New Tri Star Surface Mount



The Tri Star Surface Mount is a self-contained unit with 3 LEDs. This LED light is 12 volt and offered in a white color. It is fastened using three #8 screws. The Tri Star Surface Mount is perfect for mounting to posts in railing applications to illuminate the decking. Use with the Micro Star™ Transformers.



Micro Star™
in SunRail™ Nautilus

FEATURES & BENEFITS

Code Compliant

Due to new code requirements for stairway illumination, Atlantis Rail offers Post Caps to help customers with code compliance.

Small in Size

Patented Micro Star™ LED Lights measure only 1/4" in diameter and 7/8" in length and can fit almost anywhere with ease, even into curved surfaces such as tubular railings.



Ease of Installation

Micro Star™ LED Lights and Post Caps arrive pre-wired for simple connection and quick installation.

MICRO STAR™ TRANSFORMER



ITEM	AMP	A (width)	B (height)	C (depth)	SOURCE	WT (lb)
------	-----	--------------	---------------	--------------	--------	------------

DC TRANSFORMERS						
S0832-0001	1	2.72"	3.53"	2.21"	100-240Vac - 50/60HZ	0.70
S0832-0005	5	1.97"	5.51"	1.42"	100-240Vac - 50/60HZ	1.65

NOTE:
DC transformers are comprised of heavy-duty water resistant material. Use with Micro Star™ LED lighting. Risk of electrical shock. Install only to a covered class A GFCI receptacle that has a weatherproof enclosure with the attachment plug cap inserted or removed. S0832-0005 features 6 ft. power cord and 10 ft. connector lead.

MICRO STAR™ LED LIGHT

HOUSING: 316 STAINLESS

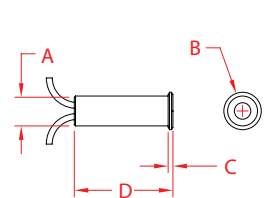

ITEM	A	B	C	D	E	COLOR	WT (lb)
------	---	---	---	---	---	-------	------------

12 VOLT DC							(wire)
S0801-0000	1/4"	0.312"	0.09"	0.825"	24.00"	white	0.02

CAUTION: USE DC TRANSFORMER ONLY

NOTE:
The smallest self-contained LED on the market. Only needs 1/4" bore for housing or 3/8" hole if used with grommet. Micro Star™ LED Light sits flush in recessed area. Sealed with waterproof epoxy. Each bulb has a life cycle of 25,000 hours. Use with the low voltage transformer (Micro Star™ Transformer) and wiring.



TRI STAR SURFACE MOUNT LIGHT

HOUSING: 316 STAINLESS

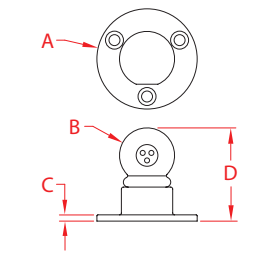

ITEM	A	B	C	D	COLOR	FAST.	WT (lb)
------	---	---	---	---	-------	-------	------------

12 VOLT DC							(size)
S0803-1000	1-1/8"	2.00"	0.13"	1.86"	white	#8	0.40

CAUTION: USE DC TRANSFORMER ONLY

NOTE:
Self-contained ball housing with 3 LED lights. Mounts to surfaces using 3, #8 screws. Ideal for mounting to railing posts for surface illumination. Use with the low voltage transformer (Micro Star™ Transformer) and wiring.



MICRO STAR™ LED POST CAP VINYL

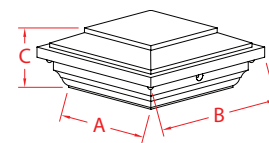
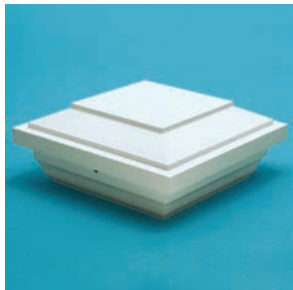

ITEM	A	B	C	WT (lb)
------	---	---	---	------------

S0985-0000	4.03"	5.75"	2.13"	0.43
-------------------	-------	-------	-------	------

CAUTION: USE DC TRANSFORMER ONLY

NOTE:
Post cap includes 4 super bright white LED lights in each corner. It provides sufficient lighting for stairs and walkways. Cap fits over standard 4"x4" vinyl sleeves and is compatible with the RailEasy™ Sleeve and Micro Star™ Transformer. Post cap arrives pre-wired for easy and quick installation. Fasteners included.

RAIL CARE GUIDE

Keep Your Railing Looking Like the Day it was Installed!



Stainless steel products cannot be regarded as completely maintenance free. Low maintenance depends largely on the care given during the first year.

After the initial installation of your railing: Clean thoroughly with automobile soap (mild car wash soap). Field passivate any place where tools have come in contact with your railing or components. Clean your railing again after passivation with warm water and automobile soap. Rinse thoroughly with fresh water. Follow with a protective polish, such as Prism metal polish.

General maintenance: Clean the railing when it's dirty in order to restore its original appearance. Polish as needed to maintain the desired luster.

For the Rail Care Guide download, please visit our website: <http://www.atlantisrail.com/downloads>

MAINTAINING YOUR STAINLESS STEEL RAILING

Extra Care in Working (Construction) Environments

Working environments create aggressive conditions. Proper cleaning must always be done immediately after installation of an Atlantis Rail product and should be repeated often if there is long exposure to working environments. Leaving a new installation without cleaning and then exposing it to a working environment will cause a high potential for corrosion. Be very mindful of the kind of work taking place around your stainless steel and protect the railings if possible.

Work Site Cleaning Solutions, Beware!

Most simple cleaning solutions, when used in accordance with their makers' instructions, are safe for incidental contact with stainless steel, but if used incorrectly, they can cause discoloration and corrosion on the surface of stainless steel by affecting the protective elements of the metal. Strong acid and chemical solutions (e.g. hydrochloric acid, muriatic acid, methyl ethyl ketone or "spirit of salts") are sometimes used to clean masonry, tiling and heavy paint clean-up of buildings, but they should **never be permitted to come into contact with your stainless steel**. It is safe to assume that anything you would not clean the aesthetic surfaces of a fine automobile with should not come in contact with your stainless steel railings. If contact of such a solution should happen, the solution must be removed immediately by copious water flushing and cleaning with a mild automobile (car wash) detergent. Anything containing a harsh acid or chemical coming in contact with stainless steel will potentially cause reactions that can lead to corrosion.

Use of Iron tools or Cutting in Proximity of Stainless Steel

The use of bare iron tools such as crescent wrenches, pliers, channel locks and allen wrenches should be avoided. Use tools with chrome plating. If such tools are used, the iron deposits, though not visible, will rust and potentially cause the stainless steel in contact with it to rust. Cutting anything with a power saw in proximity of your stainless steel railing will contaminate the area causing iron particles to be airborne, rusting wherever they land. Grinding will also have the same effect. Any contaminated surfaces should be treated with copious water flushing and cleaning with a mild automobile (car wash) detergent. We also recommend the use of a passivation fluid such as Citrisurf to guarantee the surfaces are cleaned and sealed.

Use of Fasteners with Stainless Steel

All fasteners should be the same grade stainless steel if possible. Mixing carbon steel and plated fasteners will cause corrosion where they meet the stainless steel. Nearby steel items, either attached to or over-hanging, can cause corrosion to spread. Mixing metals can cause "electrolysis" to occur, creating corrosion.

Salt Water Environments

In salt water environments we recommend electro-polishing all components and using specialized stainless steel tubing. This additional process is not a guarantee against discoloration, but it does provide the greatest protection for your stainless steel system. The treatment is relatively low cost for most systems. ****If you are on the ocean front, please entertain the electro-polish process. Return of standard parts for electro-polished parts will not incur return charges.***

RAIL CARE KIT



CLEANING / MAINTAINING

KIT INCLUDES:

- 1 - Spray Bottle of Passivating Fluid
- 1 - Microfiber Polishing Cloth
- 1 - Cup of Metal Polish
- 1 - Bottle of Car Wash Soap



ITEM	DESCRIPTION	WT
		(lb)
E0100-K000	Designed for cleaning / maintaining stainless steel railing systems	1.48
NOTE: Kit includes everything needed to keep your stainless railing system clean and protected. Clean the metal with the car wash soap when it's dirty and use the metal polish to provide a protective layer. If the metal surface scratches, use the passivating fluid to neutralize any possible contamination of the stainless surface.		

PASSIVATING FLUID



ITEM	SIZE	WT
	(fl.oz.)	(lb)
E0100-0000	22	1.60
NOTE: Fluid consists of citric acid. There are no hazardous ingredients. Use passivating spray on stainless hardware before exposure to the elements. Spray brings Nickel content in stainless to the surface, preventing discoloration or surface rust. Harmful if swallowed. May cause eye burns or skin irritation. Avoid inhalation, may cause irritation to nose and throat. Eye protection and face mask are recommended.		

METAL POLISH



ITEM	SIZE	WT
		(lb)
PRISM POLISH - GEL		
E0100-P001	7 oz.	0.51
E0100-P002	16 oz.	1.14
E0100-P003	1 gal.	10.26
PRISM POLISH - LIQUID		
E0100-P004	8 fl. oz.	0.66
NOTE: Prism Polish is formulated to clean, polish and protect all metals in one application. It contains no harsh acids, caustics or abrasives. Prism Polish is non-toxic and non-flammable. Apply a small amount of Prism Polish using a soft cloth. There is no need to let Prism Polish dry. Simply buff off with a clean soft cloth until all residue is gone.		

CLEAR SURFACE PROTECTANT



ITEM	SIZE	WT
		(lb)
NYALIC® CLEAR SURFACE PROTECTANT		
S0921-0001	12 oz.	1.05
S0921-0002	1 quart	2.32
NYALIC® CLEARCOAT TOUCH-UP KIT		
E0100-N001		2.14
Kit includes: (1) Nyalic® 12-ounce aerosols, (1) Simple Prep™ 4-ounce bottle (degreaser), (1) Right Rinse™ 4-ounce bottle (cleanser), (1) Tuff Prep™ 4-ounce bottle (micro-abrasive gel), (1) Scrub pad, (1) Pair of Nitrile Gloves and (1) White towel.		
NOTE: Nyalic® is a crystal clear polymeric resin that provides long term protection of your stainless steel railing system. Use touch-up kit to repair scratches.		

MICROFIBER POLISHING CLOTH



ITEM	SIZE	WT
		(lb)
E0100-F007	16" x 16"	0.15
NOTE: Microfiber Polishing Cloth effortlessly cleans and polishes all metals, fiberglass and plastics. Washable and reusable up to 100 times. Microfiber technology polishes and buffs faster and easier than cloth. Removes fingerprints and oils in one wipe. Use wet or dry. Streak-free performance. Works electrostatically.		



Made in USA



Import



Drop Forged



Precision Cast



Precision Machined



Stamped



Wire Formed



Electro-Polished



New Product

RailEasy™ Retail Display

RAILEASY™



Exclusive Offer

The RailEasy™ Retail Display is offered exclusively to Atlantis Rail Authorized Dealers. The initial display order consists of the products pictured to the right which construct the RailEasy™ Cable Railing System. Also, the display comes complete with the racking, signage, tear-off RailEasy™ Project Planners and quick reference guides.



ATLANTIS RAIL AUTHORIZED DEALER BENEFITS

- Exclusive referral program — only authorized dealers receive referral leads
- Online presence through the Dealer Locator page on the Atlantis Rail website
- Co-marketing support for your local events and advertising
- Free freight on most orders
- Selling the finest stainless steel cable railing systems on the market today
- Increased store traffic and valuable cross-selling opportunities
- Several available choices in stainless steel railings at stock program prices
- Free design services
- Extensive marketing within the industry
- Reasonable stocking requirements with access to our entire product line



HANDISWAGE™



HandiSwage™ Retail Packaging

Offer your customers an alternative cable railing system with the HandiSwage™ retail program. The packaging has the eye-catching HandiSwage™ logo and brilliant colors. This program includes hand swage studs, tensioners, cable, nut sets, cable sleeves and hand swage tools. Many of the products in this line are available in packs of 2 or more. Contact your Atlantis Rail Sales Representative for more details.

CABLE RAILING STYLES



Atlantis Rail offers a variety of cable railing systems to choose from to match every style and budget. These systems have a few distinct differences including cable diameter, fittings, post style and handrail style. **RailEasy™** systems utilize customer supplied posts, 5/32" cable and mechanical swage fittings. **SunRail™** systems also include 5/32" cable and mechanical swage fittings, but feature stainless steel 2" round posts and either a stainless steel top rail or a customer supplied wood top rail. **HandiSwage™** Cable Railing System uses 1/8" or 5/32" diameter stainless cable and hand swage fittings. The customer must supply their own wood top rail and posts. The **Spectrum** System utilizes HandiSwage™ fittings, 1/8" or 5/32" diameter cable, powder-coated square posts and a customer supplied flat handrail. The **NOVA** Systems feature HandiSwage™ fittings, 1/8" diameter cable and powder-coated aluminum posts, handrails and foot rails.



Visit the **Railing Gallery** to find inspiration and to see what others have designed using these cable railing systems.

RAIL EASY™



RailEasy™ Cable Railing (pg. 5)
5/32" Cable railing infill utilizing cable stabilizers to decrease deflection of cable over long spans.

SUNRAIL™



SunRail™ Nautilus (pg. 25)
2" Stainless steel round posts and handrail with cable and tensioners used as infill.

HANDISWAGE™



HandiSwage™ Cable Railing (pg. 21)
Customer's wood deck railing with 1/8" cable and hand swage fittings used as infill.



RailEasy™ Nautilus (pg. 4)
5/32" Cable and tensioners as infill with stainless steel round handrail and optional bottom rail.



SunRail™ Nautilus (pg. 26)
Complete stainless steel cable railing system featuring 5/32" cable and optional bottom rail.



Spectrum System (pg. 16)
1-1/2" Stainless steel square surface mounted posts with cable infill and customer supplied handrail.



RailEasy™ Cable Railing (pg. 5)
Customer supplied wood posts and handrails combined with 5/32" cable and tensioners as infill.

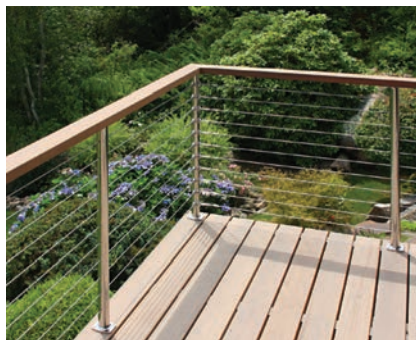

SunRail™ Latitude (pg. 28)
Customer supplied wood handrails with stainless steel round posts, 5/32" cable and tensioners.



NOVA System (pg. 18)
Powder-coated aluminum posts, handrails and foot rails with HandiSwage™ fittings and 1/8" cable.

HOW TO MEASURE FOR AN ATLANTIS RAIL SYSTEM

We encourage our customers to order from local authorized dealers to ensure personal service, local representation and project assistance.

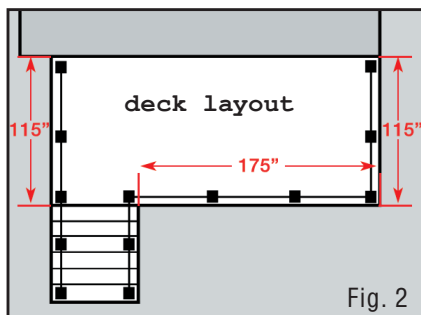
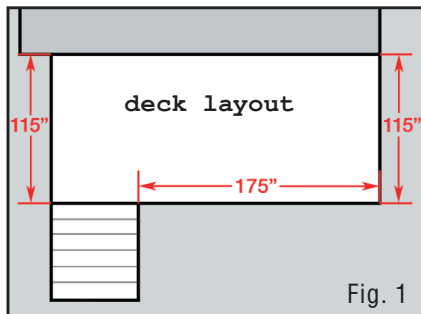

STEP 1 - Select a railing model

Based on the available selections, choose a model.

STEP 2 - Sketch your project

Sketch your project to scale. Start from the left and measure from each end to the next end or corner (Figure 1). Please note the type of surface the railing system will be mounted on. If using posts other than those supplied by Atlantis Rail, take care to indicate the location on the sketch (Figure 2).

Post and Rail Mounting Surfaces Note: Atlantis Rail Systems provides a variety of mounting options for posts and rails used in our systems. Products of this nature require that mounting surfaces are constructed to be considered structural per building code definition for the surface material used. Structural integrity and building code compliance of mounting surfaces are the responsibility of the end user and / or installer. The use of any of our mounting methods are at the option and decision of the end user and /or installer and should be selected to match the structural material used to create the mounting surface.

STEP 3 - Determine the required rail height of each section

Railing sections are offered in standard heights of 36" and 42". Custom heights are available upon request. Refer to your local building codes and note the required rail height for your project.

STEP 4 - Determine supplies for your project

We encourage you to contact your local authorized dealer. To find a dealer in your area, refer to the "Find a Dealer" page on the Atlantis Rail website or call (800) 541-6829 for assistance. If a dealer is not located in your area, please fax or email your project sketch with written dimensions to Atlantis Rail Systems: (508) 732-9798 or info@atlantisrail.com.



Use our **Dealer Locator** to find a Dealer near you.

Index

CABLE RAILING STYLES, 37

COMPANY BACKGROUND, Inside Back Cover

COMPANY POLICIES, Inside Back Cover

Payment Policy, Inside Back Cover

Return Policy, Inside Back Cover

Warranty, Inside Back Cover

CONTACT INFORMATION, Inside Front Cover

CABLE STABILIZER SAFETY INFORMATION & REQUIREMENTS, 15

GLASS SYSTEMS, 30

Product Information, 30

Specifications, 30

RailEasy™ Glass, 30

Spectrum Glass, 30

SunRail™ Glass, 30

GLASS SYSTEMS COMPONENTS, 31

Glass Panel Base, 31

Glass Panel Connector – 3/8", 31

Glass Panel Connector – 1/2", 31

Glass Panel Connector – Flat, 31

RailEasy™ Glass Panel Kit, 31

HANDISWAGE™ COMPONENTS, 22-23

After Swage Gauge, 23

Cable Grip Pad, 23

Hand Swager, 23

HandiSwage™ Cable, 23

HandiSwage™ Cable Sleeve, 23

HandiSwage™ Cover Nut Sets, 23

HandiSwage™ Flush Fitting, 22

HandiSwage™ Lag Stud, 22

HandiSwage™ Long Stud, 22

HandiSwage™ Studs, 22

HandiSwage™ Tensioner, 22

Stainless Nut Sets, 23

Stair Spacers, 22

HANDISWAGE™ RETAIL PACKAGING, 36

HANDISWAGE™ SYSTEM, 21

Overview, 21

MEASURING GUIDE, 39

MICRO STAR™ LED LIGHTING, 32-33

Features & Benefits, 32

Overview, 32

MICRO STAR™ LED LIGHTING COMPONENTS, 33

Micro Star™ LED Light, 33

Micro Star™ LED Post Cap, 33

Micro Star™ Transformers, 33

Tri Star Surface Mount Light, 33

NEW PRODUCTS, 2

NOVA SYSTEMS, 18

HandiSwage™ Cable Infill, 18

NOVA, 20

NOVA SYSTEMS (continued)

Post Kits, 20

Rail Kits, 20

Specifications & Options, 20

NOVA II, 19

Post Kits, 19

Rail Kits, 19

Specifications & Options, 19

NOVA Cover Nut Set, 19

NOVA Grommets, 20

NOVA Tensioner Backing Disk, 19

Overview, 18

Surface Mounting, 18

PHOTO CONTEST, 2

QUOTE REQUEST FORM, 38

RAIL CARE GUIDE, 34

RAIL CARE PRODUCTS, 35

Clear Surface Protectant, 35

Metal Polish, 35

Microfiber Polishing Cloth, 35

Passivating Fluid, 35

Rail Care Kit, 35

RAILEASY™ COMPONENTS, 10-15

Cable Cutter, 12

Cable Lacing Needle, 12

Cable Stabilizer Kit, 15

Cable Stabilizer Kit - Adjustable, 15

Cable Stabilizer Kit - Aluminum, 15

Fastener Lubricant, 13

Rail Wood Screw, 13

RailEasy™ Adjustable Sidemount, 14

RailEasy™ Cable, 12

RailEasy™ Cable Cutter, 12

RailEasy™ Cable Sleeves, 12

RailEasy™ Colonial Post Base, 14

RailEasy™ Colonial Post Cap, 14

RailEasy™ Cones – 4 Pack, 11

RailEasy™ Drilling Template, 13

RailEasy™ Flush Fitting, 10

RailEasy™ Installation Tools, 12

RailEasy™ Lag Stud, 11

RailEasy™ Sleeve, 15

RailEasy™ Straight Sidemount, 13

RailEasy™ Stud Assembly, 11

RailEasy™ Stud, 11

RailEasy™ Swivel End – Flat, 10

RailEasy™ Swivel End – Round, 10

RailEasy™ Tensioner – Flat, 10

RailEasy™ Tensioner – Round, 10

RailEasy™ Tubing, 14

RailEasy™ Wedges – 10 Pack, 11

Screwdriver Bits – Stainless, 13

RAILEASY™ HARDWARE, 6-9

RailEasy™ Cable Sleeve, 9

Overview, 9

Usage Guidelines, 9

RailEasy™ Flush Fitting, 9

Overview, 9

RAILEASY™ HARDWARE (continued)

RailEasy™ Lag Stud, 8

Overview, 8

Usage Guidelines, 8

RailEasy™ Stud Assembly, 8

Installation Steps, 8

Overview, 8

RailEasy™ Swivel End, 7

Features & Benefits, 7

Overview, 7

Usage Guidelines, 7

RailEasy™ Tensioner, 6

Exploded View, 6

Features & Benefits, 6

Installation Steps, 6

Overview, 6

Tensioning Sequence, 7

RAILEASY™ RETAIL DISPLAY, 36

Benefits, 36

Overview, 36

RAILEASY™ SYSTEMS, 3-5,

Overview, 3

RailEasy™ Cable Railing, 5

Features & Benefits, 5

Product Information, 5

Specifications, 5

RailEasy™ Nautilus, 4

Features & Benefits, 4

Product Information, 4

Specifications, 4

SPECTRUM SYSTEM, 16-17

Cable Infill Option, 16

HandiSwage™ Infill, 16

Color Selection, 16

Corner Mending Plate Set, 17

Handrail Mounting Bracket, 17

Overview, 16

Post Kits, 17

Reinforcing Channel, 17

Surface Mount Cable Stabilizer Kits, 17

Top Mounting Plate Assembly, 17

Wide Mounting Plate, 17

SUNRAIL™ LATITUDE, 28-29

Cable Railing Infill, 28

Fascia Mount, 29

How to Order, 28

Overview, 28

Post Kits, 29

Stair Fitting, 29

Top Plate Mounting Assembly, 29

SUNRAIL™ SYSTEMS, 24-27

ADA Systems, 27

Commercial Systems, 26

Custom Systems, 27

Overview, 24

Residential Systems, 25

TABLE OF CONTENTS, 1

Company Policies

PLEASE READ BEFORE PURCHASING

1. ATLANTIS RAIL accepts payment by credit card, prepayment, or on approved established accounts, based on ATLANTIS RAIL'S credit policy. After an application process, a company may be accepted as a Business Partner which allows access to special pricing. A pdf file can be found on our website or ATLANTIS RAIL will send you the appropriate forms. All first orders on newly opened and special accounts are prepaid. No C.O.Ds are available.
2. Approved accounts are payable strictly within 30 days net from date of invoice. Payment received by ATLANTIS RAIL **within** 10 days from date of invoice will qualify for a 1% prompt settlement discount, **except** if such invoice has been based on special pricing.
3. Interest at 1.5% per month will be charged on all overdue accounts. Should legal proceedings and/or collection be necessary, ATLANTIS RAIL shall be entitled to recover all legal costs, including but not limited to, collection and attorney's fees and interest.
4. Prices and conditions are based on F.O.B. Plymouth, Massachusetts. All freight is payable at destination, if shipped by road freight, or prepaid and added to the invoice in case of FedEx shipments. ATLANTIS RAIL will ship by UPS on special request only. Sorry, no consignee billing.
5. ATLANTIS RAIL constantly improves its products. **Specifications are intended as a guide only, as use and applications are outside ATLANTIS RAIL'S control. They are therefore subject to change without notice, unless ATLANTIS RAIL has certified the product to the purchaser with a Test and/ or Compliance Certificate.**
6. All prices are reflected in the current Price List, which is available from ATLANTIS RAIL separately. ATLANTIS RAIL reserves the right to change prices without notice should circumstances beyond ATLANTIS RAIL'S control occur.
7. FOR STANDARD COMPONENTS ONLY - Returns may be accepted within 10 days without restocking charge. A 15% restocking charge will be deducted from all credits covering returns after 10 days. **Any custom rail system or custom cut tubing cannot be accepted. Please always obtain a Return Authorization Number (RA #) for qualifying returns, to avoid refusal of shipment.**
8. ATLANTIS RAIL requires a minimum order of \$50.00, excluding freight.

IMPORTANT ~ PLEASE READ BEFORE PURCHASING:

It is a condition of any sale that ownership of the goods remains the sole property of ATLANTIS RAIL SYSTEMS, until payment has been received. In case of drop shipments, the consignee and the buyer jointly and severally are responsible for the payment of the goods supplied, and ATLANTIS RAIL SYSTEMS expressly reserves its right to recover full payment from the consignee in case of nonpayment by the buyer.

FOR ATLANTIS RAIL LIMITED MANUFACTURER'S WARRANTY AND WARRANTY REGISTRATION VISIT www.atlantisrail.com/legal

Company Background



Atlantis Rail is committed to raising the bar of excellence one customer at a time. We invite you to experience the designs that set us apart from the rest.

A History of Excellence

Atlantis Rail Systems' heritage is very unique. The idea of using stainless steel products, such as cable and tensioners, for architectural purposes was inspired by the very lifelines and hardware that can be found on boats in every harbor across the globe. The concept of Atlantis Rail Systems was developed by Suncor Stainless, Inc., a leading manufacturer of stainless steel hardware in the industrial and marine industries. With the dedicated help of the Atlantis Rail Team, we are proud to provide custom fit railing systems worldwide.

The products illustrated within these pages provide a cutting edge approach to conventional railing systems. Through the use of patented technology and the durability of marine grade, type 316L stainless steel, we have the ability to provide customers with a superior product in both style and quality to fit any indoor or outdoor, commercial or residential design.



Our CNC band saw cuts tubing quickly and accurately, which allows for easy customization. Stock tubing can be made precisely with the pre-programmed measuring technology of the saw.



Atlantis Rail's large, 70,000 sq.ft. facility offers ample room for stocking components and efficient work flow.

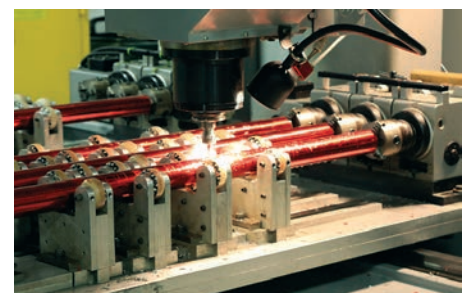

Precision CNC milling machine.

Stainless steel products cannot be regarded as completely maintenance free. Low maintenance depends largely on the care given during the first year.

Thank you for making Atlantis Rail Systems your number one source for quality stainless steel railing products!

IMPORTANT NOTICE

All contents of this catalog, including all logos, icons, product images and descriptions are the sole property of Atlantis Rail Systems. The making and distribution of copies or reproductions of any product/section image or description within this catalog in printed, electronic or any other format is strictly prohibited. Exceptions, other than for consideration in purchasing product from Atlantis Rail Systems must be obtained in writing from the Plymouth, MA headquarters.

© 2017 Atlantis Rail Systems

CONTACT INFORMATION

Headquarters:
Atlantis Rail Systems
70 Armstrong Road
Plymouth, Massachusetts
02360

Telephone:
(508) 732-9191

Toll Free:
(800) 541-6829

Fax:
(508) 732-9798

Email:
info@atlantisrail.com

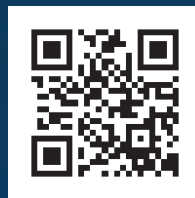

ATLANTIS[®]
RAIL SYSTEMS

WWW.ATLANTISRAIL.COM

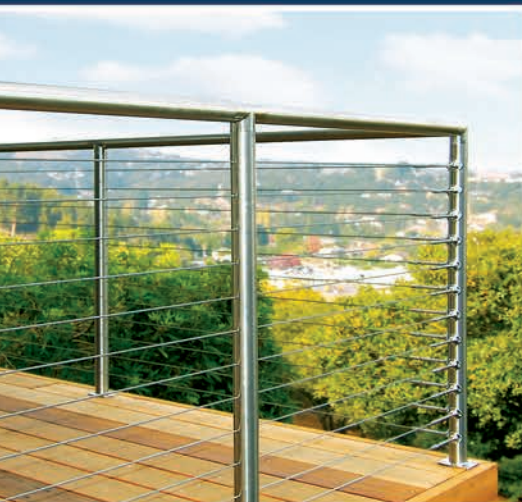

Residential • Commercial • Custom
STAINLESS STEEL RAILING SYSTEMS